



November 21, 2025

# Solicitation No. 601CT000006392 SH 288 PS&E

Limits: SH 288 from I-610 to BW 8

## Pre-RFP Informational Presentation



## Housekeeping



Be sure to provide your information on the sign-in sheet.



Please mute your phones.



**NO** recording nor photography of this presentation.



You may ask questions at the end of the presentation.

## Ground rules

- Do not contact Houston District staff regarding this procurement. Contact PEPS procurement engineer for questions.
- This presentation is for INFORMATIONAL PURPOSES ONLY.
- The advertised RFP will dictate the final work categories. Read and comply with the RFP requirements.



## Table of Contents

**5** | SH 288 System Overview

**7** | Project Overview

**22** | PS&E Contract Information & Tentative Timeline

**31** | Request for Proposal



November 21, 2025

# SH 288 System

## Harris County

## SH 288 System

- SH 288 Toll Lanes were constructed under a Comprehensive Development Agreement (CDA) with Blueridge Transportation Group (BTG).
- **TxDOT Executed CDA with BTG:** March 4, 2016
- **SH 288 Toll Lanes open:** November 16, 2020
- **Termination of CDA:** October 8, 2024
- Texas Transportation Finance Corporation (TTFC) was created to acquire, develop, finance, design, construct, reconstruct, expand, toll, operate and maintain the SH 288 Managed Lanes Project which includes all tolled and non-tolled facilities.





November 21, 2025

# Project Overview

## SH 288 Expansion Project

### Houston District

## Project Overview:

- **Total Project Length:** 5-Miles
- **Limits:** I-610 to BW 8
- **FONSI:** May 23, 2013
- Ultimate schematic prepared in 2013.
- Updated Ultimate Schematic currently under development

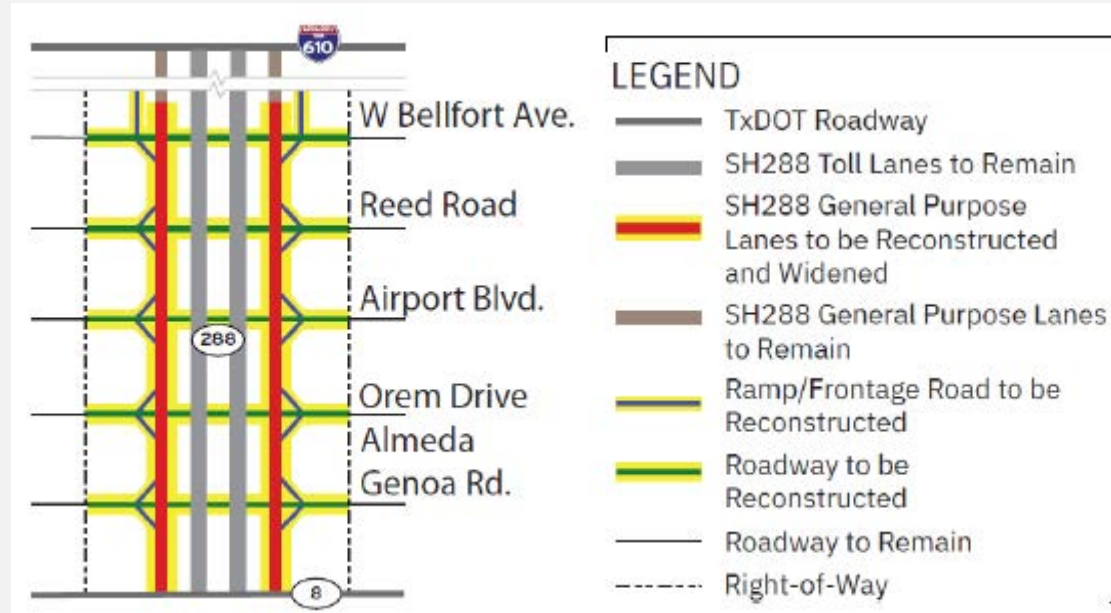



## Preferred alternative SH 288 from I-610 to BW 8:

### SH 288 between IH 610 and BW 8

The proposed project would increase the number of general-purpose lanes in each direction along SH 288, with auxiliary lanes for entrance and exit ramps. The proposed project includes the following improvements:

- ➡ • Construct one additional general-purpose lane in each direction.
- Construct two toll lanes in each direction within the SH 288 median.
- Construct southbound exit ramp from toll lanes to general-purpose lanes, north of Reed Road.
- Construct northbound entrance ramp from general-purpose lanes to toll lanes, south of Reed Road.
- Construct southbound exit ramp from toll lanes to general-purpose lanes, south of Alameda-Genoa Road.
- Construct northbound entrance ramp from general-purpose lanes to toll lanes, north of Alameda-Genoa Road.
- Construct southbound exit ramp from general-purpose lanes to frontage road, south of Alameda-Genoa Road.
- Construct southbound connection from frontage road to access road, north of BW 8.
- Construct southbound frontage road between Alameda-Genoa Road and BW 8.
- Construct southbound entrance ramp from frontage road to general-purpose lanes, north of BW 8.
- ➡ • Widen existing SH 288 bridges at Airport Road, Sims Bayou, and W. Orem Drive.
- ➡ • Reconstruct and widen existing bridges at Reed Road and Alameda-Genoa Road.

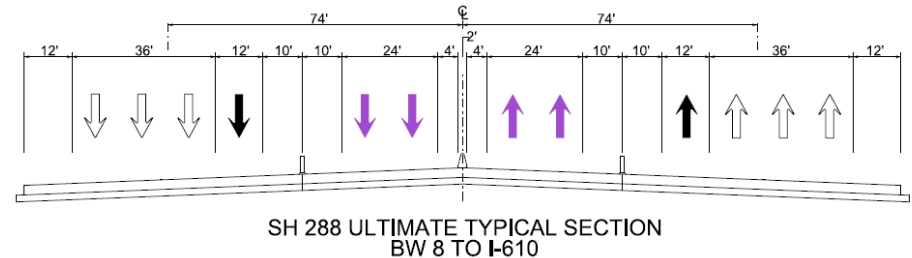

- Reconstruct ramps and cross streets within the TxDOT ROW
- Potentially converting two-way frontage road between Alameda Genoa Rd. and BW 8 to one way

## Proposed Typical Section:

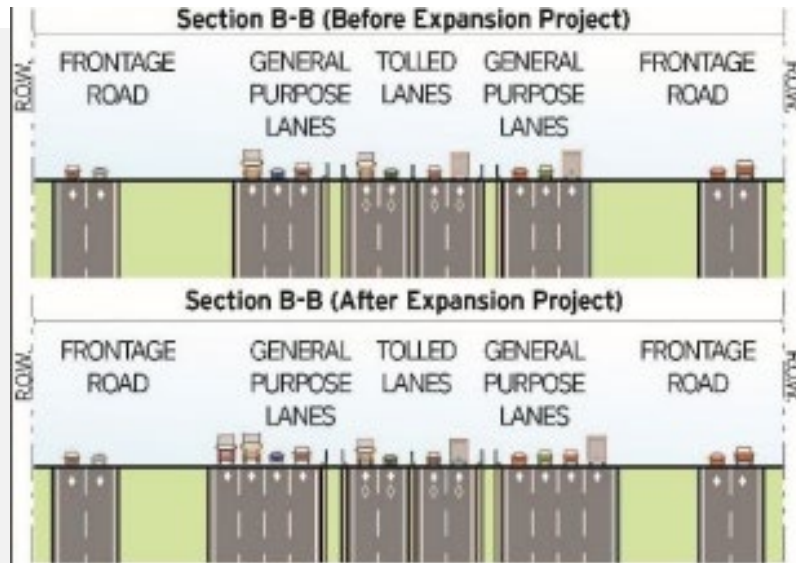
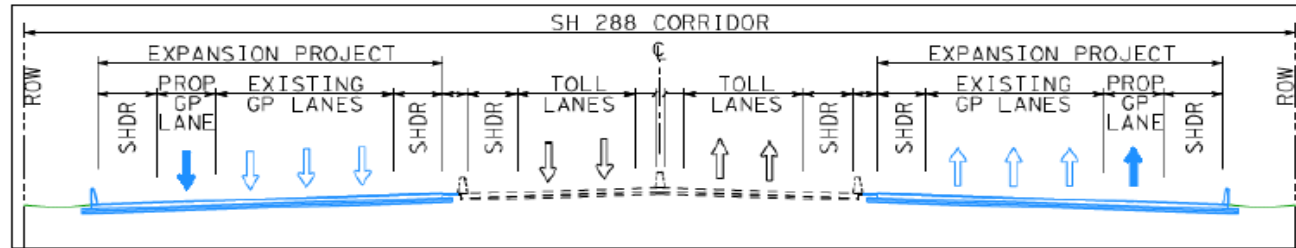

## CSJ 0598 01 106

- **Construction Limits:** SH 288 from I-610 to North of Sims Bayou
- **Project Length:** 2.5 Miles
- **Project Locations:** Harris County
- **Project Description:** Reconstruct and widen roadway – Add lanes
- **Project Details:** Reconstruct and widen from 6 to 8 General Purpose Mainlanes
- **Estimated Letting Date:** March 2029
- **Estimated Cost:** \$150M

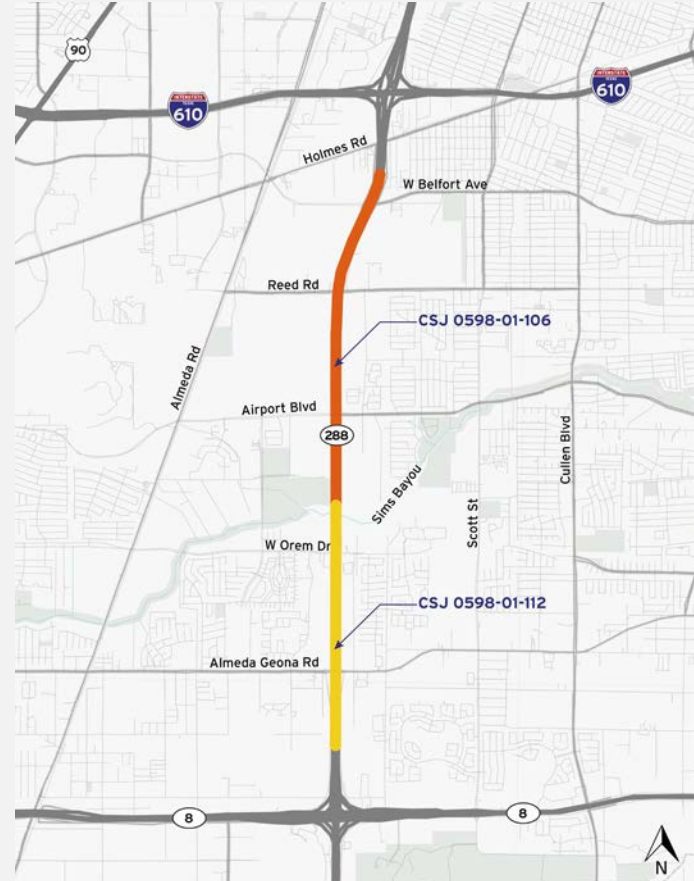

## CSJ 0598 01 112

- **Construction Limits:** SH 288 from North of Sims Bayou to BW 8
- **Project Length:** 2.5 Miles
- **Project Locations:** Harris County
- **Project Description:** Reconstruct and widen roadway – Add lanes
- **Project Details:** Reconstruct and widen from 6 to 8 General Purpose Mainlanes
- **Estimated Letting Date:** March 2030
- **Estimated Cost:** \$100M

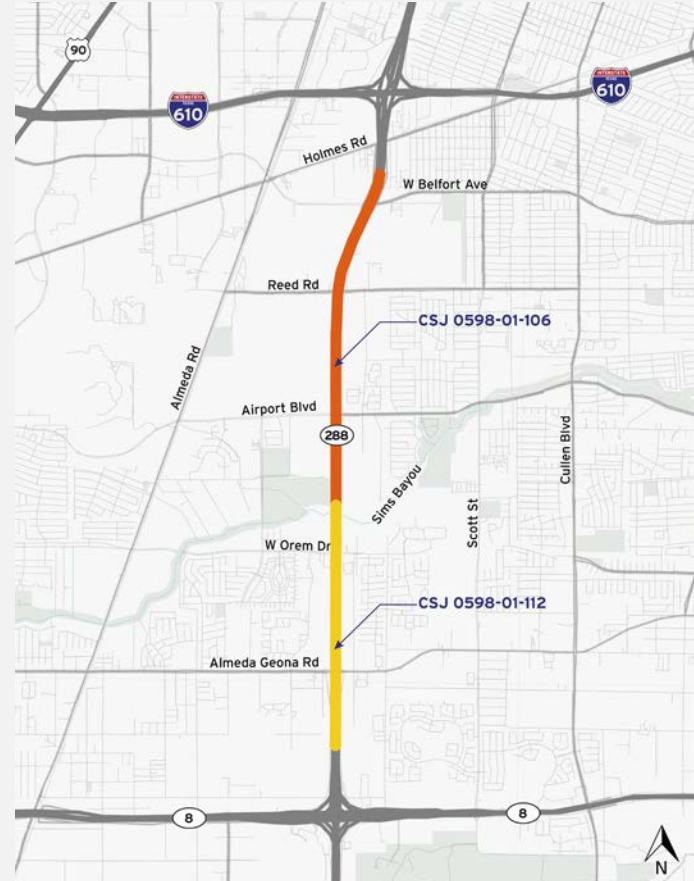

- **Project needs**

- Expanding capacity: The project would address transportation demand in the area, reduce traffic congestion, and provide travel options.
- Safety: This project would address roadway geometry and aging infrastructure as well as improve intersection safety.
- Economic development: The project would accommodate demographic and economic growth by improving the movement of persons and goods.

- **Project purpose**

- The purpose of the project is to provide additional general purpose main lane capacity to provide drivers with options to either use the toll lanes or free lanes, enhance mobility, respond to economic growth. This was a commitment made when the SH 288 CDA was terminated in October 2024.

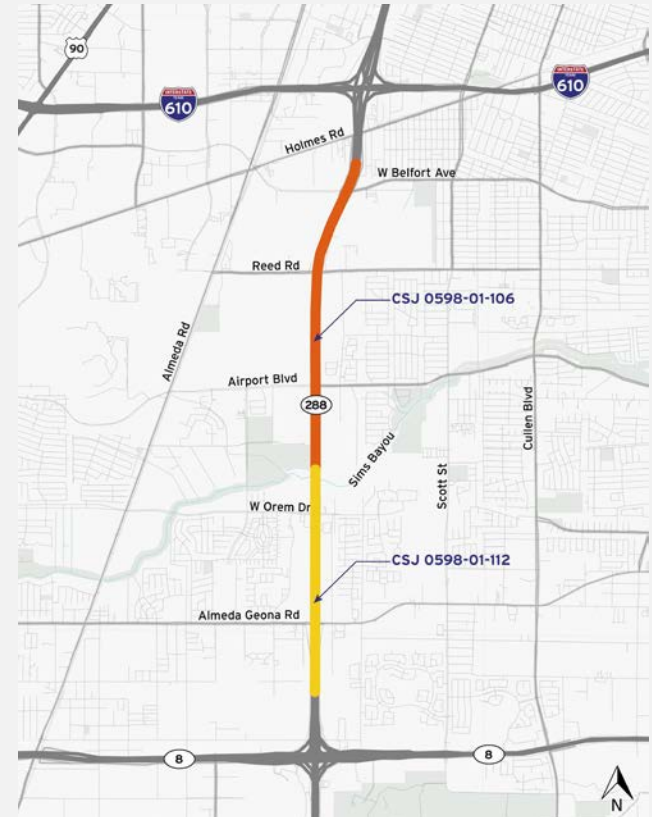



## Project elements

- Bridge
- Retaining Wall
- Pavement
- High mast illumination
- Underpass lighting
- Traffic Signals
- Pavement markers and markings
- Intelligent Transportation Systems (ITS)
- Traffic Control Plans (TCP)
- Stormwater Pollution Prevention Plan (SWPPP)
- Drainage
- Cantilever Overhead Sign Structure/Overhead Sign Structure (COSS/OVHD) and roadside signage
- Utility Conflict Identification and Resolution
- Green Ribbon Standard – WAVE Scheme

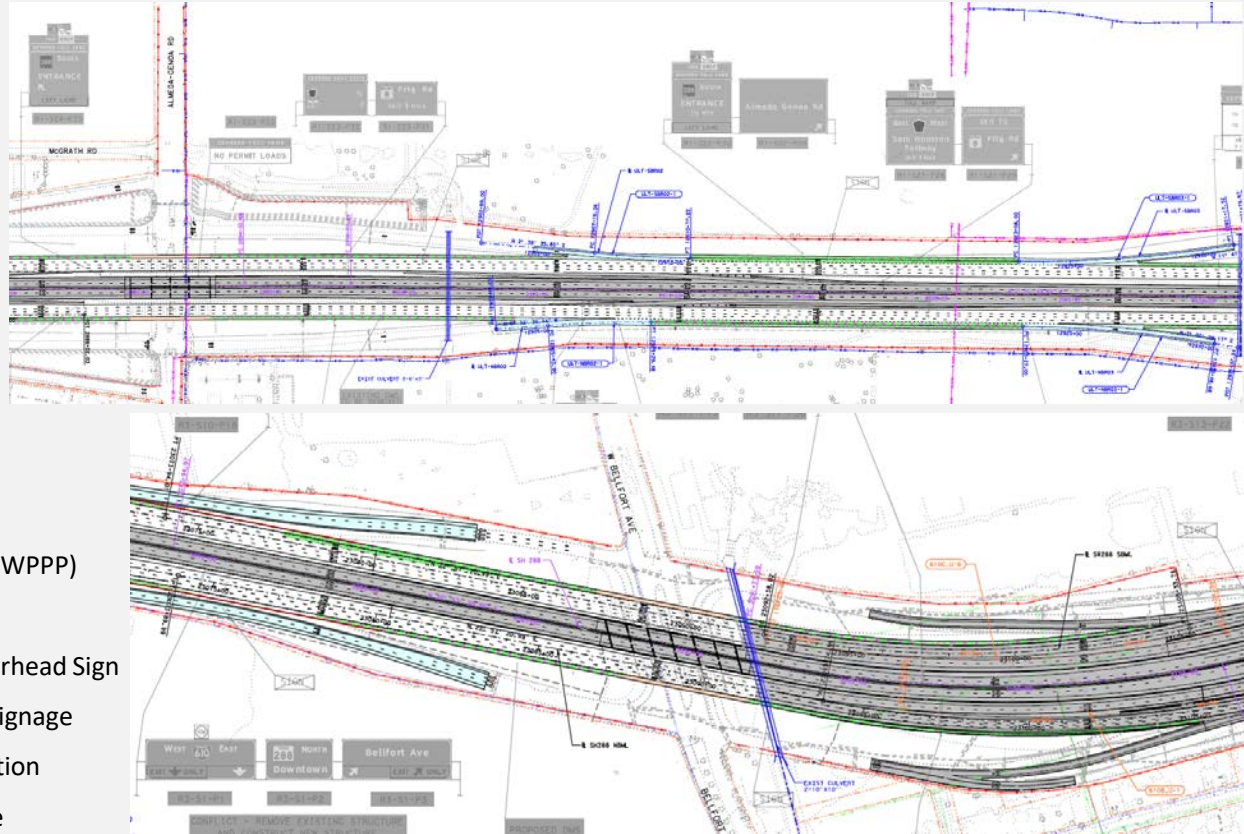

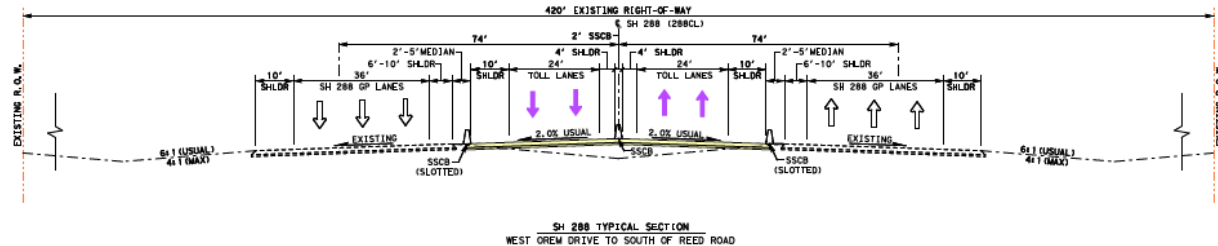
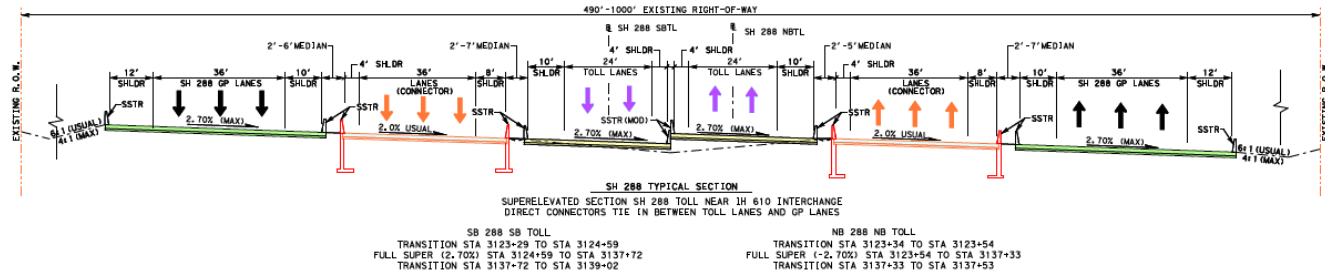
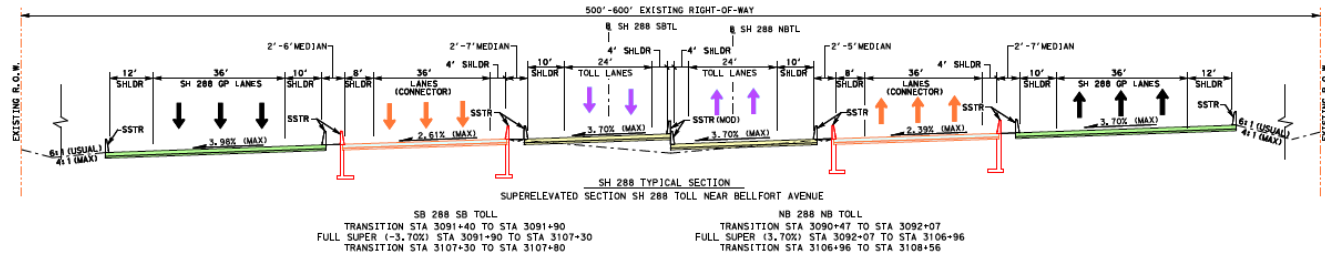

## SH 288 Box Culvert Crossings (7 total)

CSJ 0598-01-106: 4 Box Culvert Crossings

CSJ 0598-01-112: 3 Box Culvert Crossings





## Existing Sign Structures

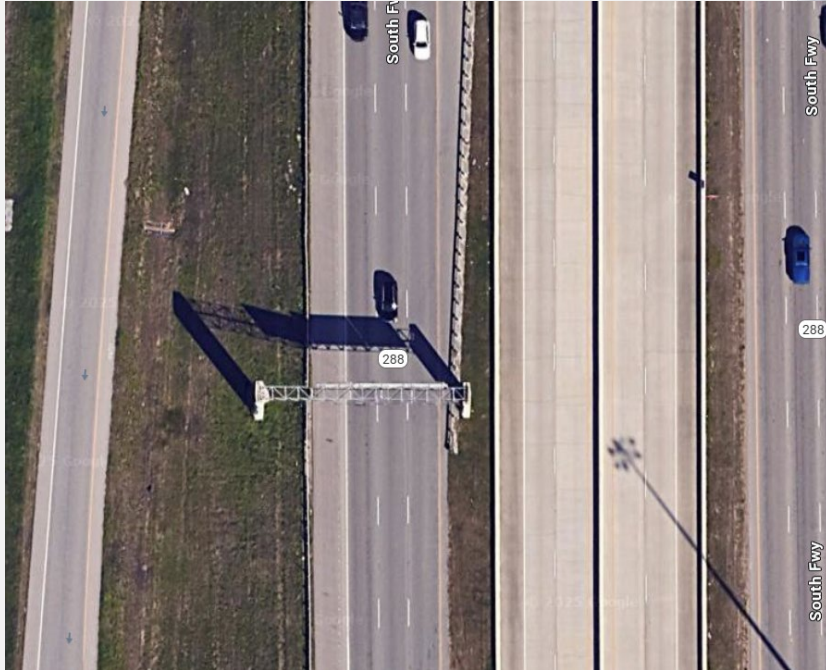



Impacts to Time of Day toll rate signs will need to be minimized. Signage needs to be operational at all times and cameras must be able to view toll rates at all times of the day.

## SH288 Managed Lanes Project: Interchanges & Tolling Points

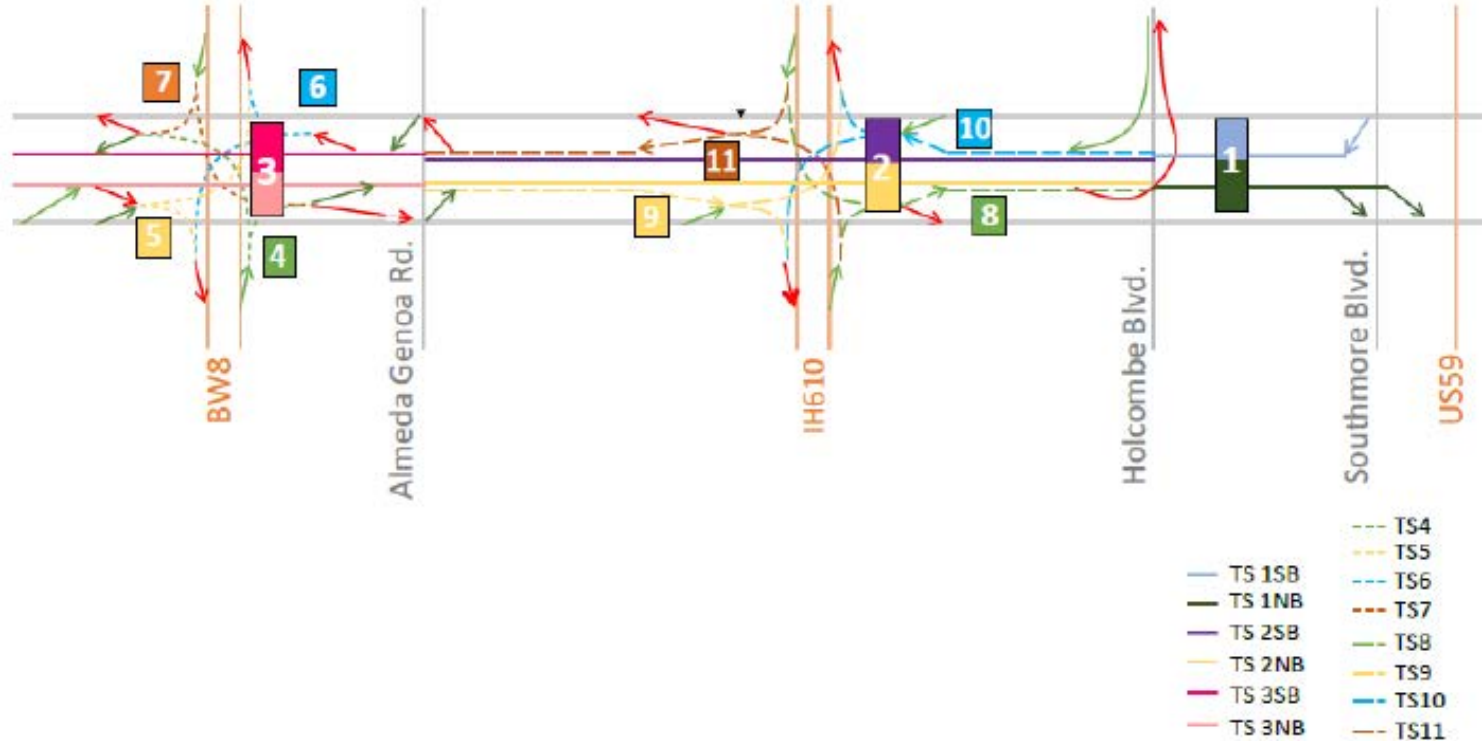

## Major Project Schedule Milestones

- Updated schematic available Late Summer 2026
- *Target Letting Date: March 2029 (CSJ 0598-01-106) & March 2030 (CSJ 0598-01-112)*
- *Complete construction – 2034*
- TxDOT's goal is to have the projects designed by late 2028 to meet the letting schedule and commitments in the press release from August 2024: *“TxDOT will be prepared to begin construction of additional free lanes along portions of SH 288 by no later than 2030”*

## Project Websites

**SH 288 Manage Lanes-** <https://www.txdot.gov/business/road-bridge-maintenance/alternative-delivery/sh288-toll-lanes.html>



November 21, 2025

# PS&E Contract Information & Tentative Timeline

## Anticipated Scope Matters:

- Surveying existing for design confirmation
- No modifications to toll lanes are anticipated. Confirm if barrier slot drainage from the toll system can be maintained.
- Prior drainage was not required to meet Atlas-14; however, proposed design must meet current requirements
- Borings as required to meet current LRFD design requirements
- Identification of Right of Way needs (only anticipated if needed for drainage or intersection corner clips).  
Perform ROW mapping for any additional ROW.
- Coordinate TCP and design between adjacent projects
- Utility conflict identification and relocation coordination
- Railroad coordination at Holmes Rd (anticipate needing a maintenance consent letter (MCL))

## Information to be Provided by TxDOT:

Records from SH 288 Toll Lane Project will be provided to design team:

- As-built PDFs
- DGNs
- ROW Maps
- Utility Strip Map
- Reports : Geotech, drainage, pavement design, scour, etc.
- 3rd party agreements: City of Houston agreements
- Previous environmental documentation and permits
- Signal Warrant Studies



# Tentative Work Categories

Cat. No.	Category Name
4.2.1	Roadway Design
4.5.1	Constructability Review
4.6.1	3-D Visualization and Animation Services
4.7.1	Traffic Safety Analysis
5.2.1	Bridge Design
5.5.1	Bridge & Non-Bridge Class Culvert and Inlet Design
5.6.1	Structural Engineering for Overhead Sign Supports
7.1.1	Traffic Engineering Studies
7.3.1	Traffic Signal Timing
8.1.1	Signing, Pavement Marking & Channelization
8.2.1	Illumination
8.3.1	Signalization

Cat. No.	Category Name
8.4.1	ITS Control Systems Analysis, Design & Implementation
9.3.1	Pedestrian Facility Design
9.3.2	Accessibility Design
9.4.1	Bikeway Design
10.1.1	Hydrologic Studies
10.2.1	Roadway Hydraulic Design
10.3.1	Bridge Hydraulic Design
10.5.1	Bridge Scour Evaluations And Analysis
10.8.1	FEMA Regulations and Permits
12.4.1	Pavement Design Services
14.1.1	Soil Exploration

Cat. No.	Category Name
14.2.1	Geotechnical Testing
14.3.1	Transportation Foundation Studies
14.5.1	Evaluation & Design of Geotechnical Related Structures
15.1.1	Right of Way Surveys
15.2.1	Design Survey
15.3.1	Aerial Photogrammetry
15.3.2	Terrestrial Photogrammetry
15.3.3	Terrestrial LiDAR
15.3.4	Mobile LiDAR
15.3.5	Horizontal and Vertical Control
15.3.6	Airborne LiDAR
18.2.1	Subsurface Utility Engineering (Utility Eng. Investigation)

Cat. No.	Category Name
18.3.1	Utility Adjustment Coordination
18.4.1	Utility Engineering
18.5.1	Utility Construction Management and Verification
18.6.1	Utility Management & Coordination Oversight
18.7.1	Utility Relocation Design

## Contract Goals

Expertise in PS&E Development Process

PM & TLs expertise, ability to develop creative solutions given the tight constraints

High Quality Deliverables with short timeframes



November 21, 2025

# Request for Proposal

## Contract Information

- Federal Process with Interview – Zero DBE Goal
- 2 Specific Deliverable (SD) PS&E Contracts:
  - CSJ 0598-01-106: SH 288 from I-610 to North of Sims Bayou
  - CSJ 0598-01-112: SH 288 from North of Sims Bayou to BW 8



## Procurement Process

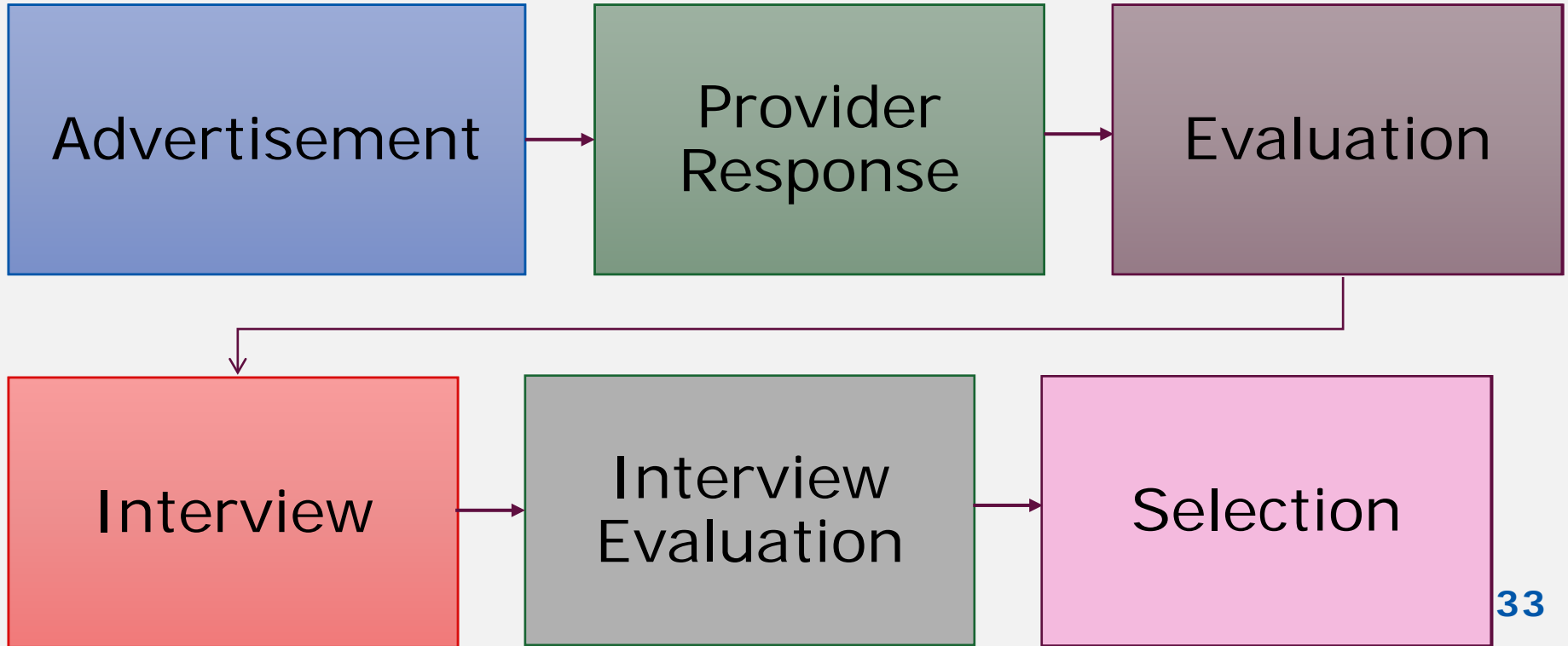

## Tentative Timeline

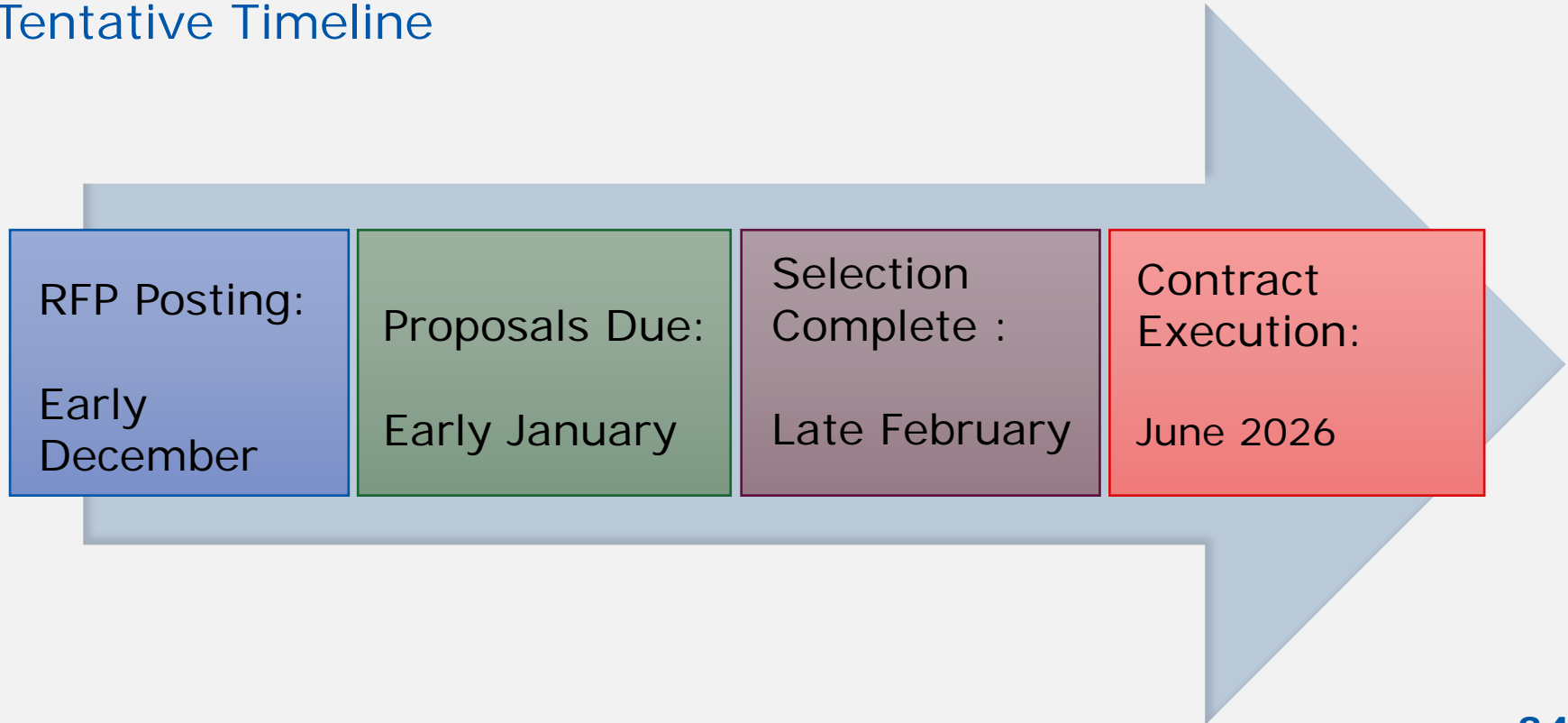

## Evaluation Criteria

Evaluation Criteria	Included Elements
Technical approach	Project understanding, project approach, innovative concepts or alternatives
Project Manager's relevant experience	Experience with similar or related projects, including both technical and management experience
Project planning and management	Project staffing and resource management (who, how, and why), communication plan, and quality control procedures. Includes the prime firm's past experience with utilizing subproviders and meeting commitments and/or how it plans to utilize subproviders on this contract. Also, may include project scheduling and phasing for SD projects
Key staff's relevant experience	Experience with similar projects
Past Performance Score	

Proposals are independently scored by CST members based on the four evaluation criteria and their corresponding weightings.

## Core Team Restriction

- The Core Team members (project manager and task leaders of the following work categories: Roadway Design, Bridge Design, and Roadway Hydraulic Design) proposed by a firm (prime or subprovider) on one Proposal, are precluded from being proposed as Core Team members on another Proposal in this solicitation. However, Core Team members could be used on other Proposals in minor supporting roles on the team.

# Conflict of Interest

## Texas Administrative Code – Conflict of Interest

According to 43 TAC §10.6, a conflict of interest is a circumstance arising out of existing or past activities, business interests, contractual relationships, or organizational structure of an entity and because of which the entity's objectivity in performing the scope of work sought by the Department is or may be otherwise impaired, the entity's ability to give impartial advice or assistance to the Department might be impaired, or because of which the entity has an unfair competitive advantage.

# Draft Preclusion Document

**NOTE: This is a draft Preclusion Document. The final Preclusion Document will be posted with the Request for Proposals in the TxDOT Procurement Portal.**

**Professional Engineering Procurement Services  
(PEPS) Division  
Solicitation Number: 601CT0000006392  
Preclusion Document**

The table below lists TxDOT contract(s) and the firms that performed services on these contracts. The firms (prime provider or subprovider) identified in the table below are precluded from participation in the contract(s) as noted in this solicitation. The preclusion also applies to any subsidiaries and affiliates of the identified prime provider or subprovider.

This list is not inclusive and does not list firms that may also be precluded due to conflicts of interest related to their participation on adjacent or intersecting projects with other entities. Conflicts of interest are defined in 43 TAC §10.6 and it is the responsibility of the prime provider to identify and confirm potential conflicts of interest for the prime firm and subproviders. Failure to identify a conflict of interest may jeopardize the selection of the provider for a contract or the award of a contract to the selected provider.

Legacy Contract No.	PeopleSoft Contract No.	Work Authorization No.	Prime Provider Name	Subprovider Name	Type of Contract	Description of Work
89-8SDP5001	8877	1	HNTB CORPORATION		GEC	Overseeing the CDA contract for the toll lanes



Legacy Contract No.	PeopleSoft Contract No.	Work Authorization No.	Prime Provider Name	Subprovider Name	Type of Contract	Description of Work
36-4IDP5099	14859	1 (Preliminary)	LOCKWOOD, ANDREWS & NEWNAM, INC.		Schematic/ Environmental	Schematic Design and Environmental Documentation
				BLANTON & ASSOCIATES, INC.		Environmental Analysis and Documents
				OTHON, INC.		Traffic Projection
				LAMB-STAR ENGINEERING, LLC		Design Survey & Mapping

# Submittal Reminders

- Submit before the deadline
- QA/QC the submittal by referring directly to the RFP
- Check that all mandatory forms are in your submittal
- Verify name of project manager and task leaders
- Verify Task Leaders are pre-certified in the listed work categories.
- Verify that your sub-providers are pre-certified in the listed work categories
- Ensure your Administrative Qualifications are up to date



After this presentation, all questions must be submitted to Basem Dia, P.E.,  
Procurement Engineer, at:

**[Basem.Dia@txdot.gov](mailto:Basem.Dia@txdot.gov)**



The deadline for questions is **November 19, 2025, at 1:00 PM**  
with the subject line:

"HOU / PS&E / Pre-RFP Meeting / Questions"



Copy of the presentation, questions, and responses will be posted at:

**<https://www.txdot.gov/business/peps/opportunities/meetings.html>**

## Questions

