

PARCEL #	PIDN	PROPERTY OWNER
67	X2049990000700	SMITH REX B
7	B80099900308500	EL PASO ELECTRIC CO
6	B80099900106525	CITY OF EL PASO
4	B80099900104900	PARKLAND CAPITAL FUND LP
3	B80099900103300	SOTO CECILIO R & GUADALUPE
2	B80099900101700	WRIGHT LEWIS SR & L JR & 2
1	B80099900100100	WRIGHT LEWIS SR & L JR & 2
64	X11499900004600	SMITH REX B & MARY H
44	Railroad Properties	RAILROAD PROPERTIES
49	State of Texas	STATE OF TEXAS
47	Railroad Properties	RAILROAD PROPERTIES
63	X11499900000200	CITY OF EL PASO
59	X01099900000550	CEMEX EL PASO INC
5	B80099900106500	EL PASO ELECTRIC CO
65	X11499900005500	CEMEX EL PASO INC

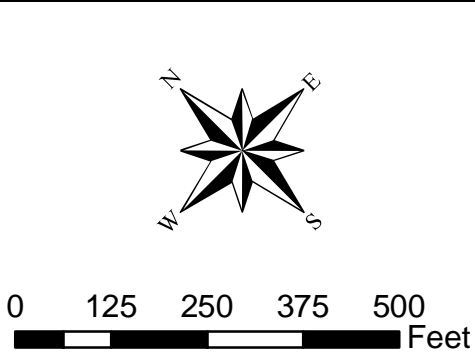
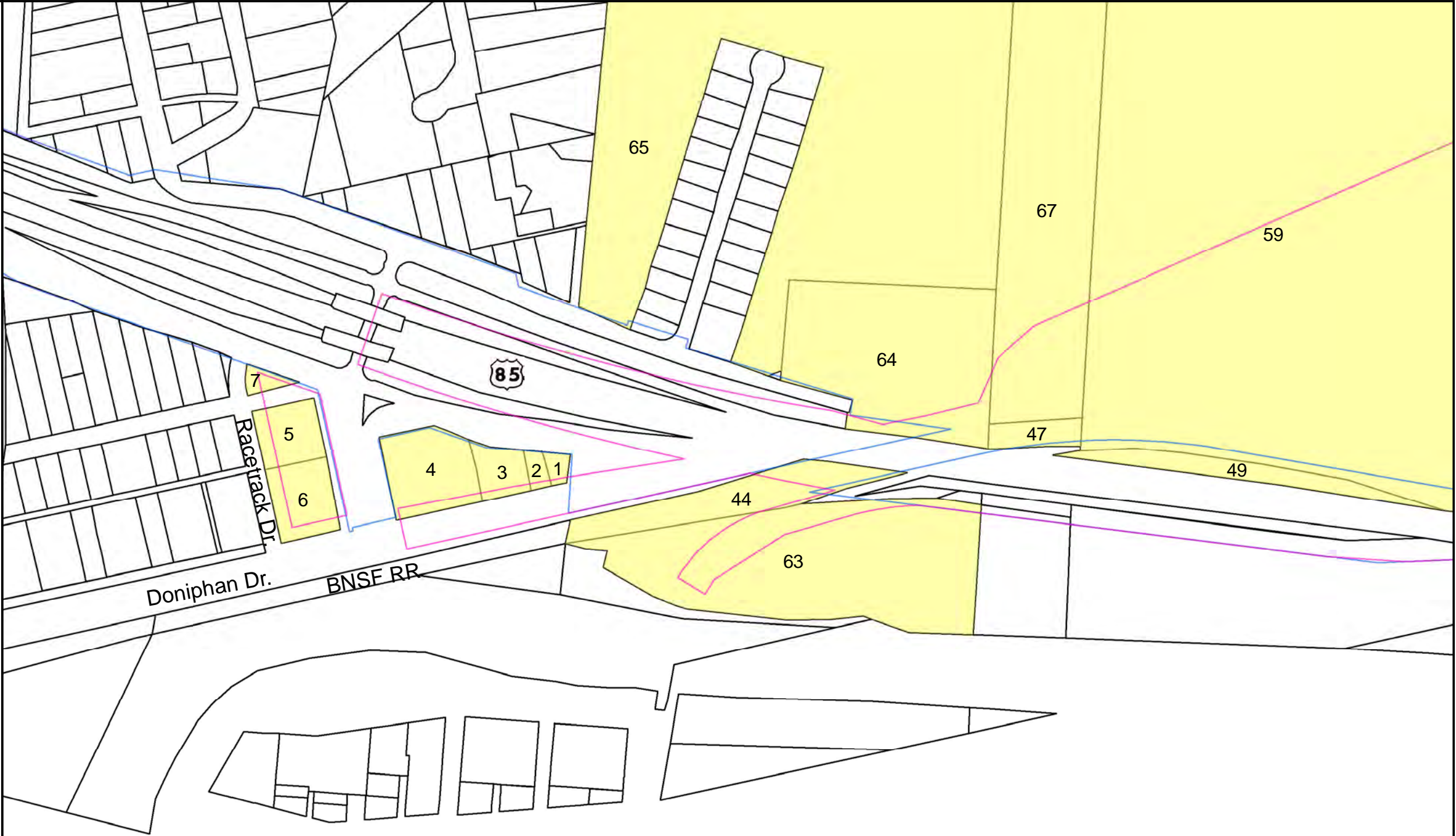

**PRELIMINARY**  
THIS PRINT IS FURNISHED FOR INFORMATION ONLY.  
THE PLAN INFORMATION OR OTHER DATA SHOWN HEREON IS  
SUBJECT TO CHANGE AND MUST NOT BE CONSTRUED AS FINAL.

© 2013 by Texas Department of Transportation;  
(512) 416-2055; all rights reserved.

DRAFT

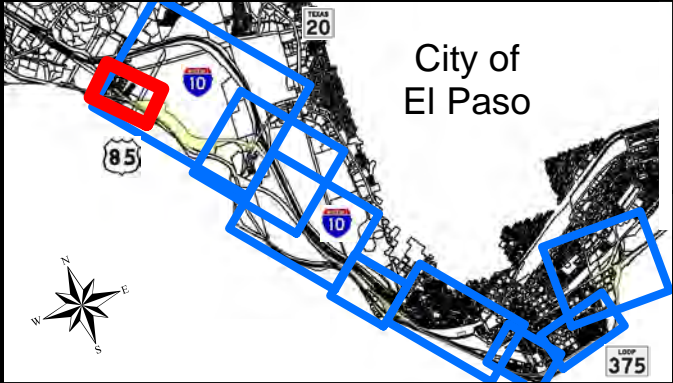

**Loop 375 Border Highway West (BHW) Extension Project**  
From Racetrack Drive to East of Park Street

**Parcel Information**  
TxDOT EL Paso District  
CSJ: 2552-04-027

Sheet 1 of 9

April 26, 2013



PARCEL #	PIDN	PROPERTY OWNER
67	X20499900000700	SMITH REX B
7	B80099900308500	EL PASO ELECTRIC CO
6	B80099900106525	CITY OF EL PASO
4	B80099900104900	PARKLAND CAPITAL FUND LP
3	B80099900103300	SOTO CECILIO R & GUADALUPE
2	B80099900101700	WRIGHT LEWIS SR & L JR & 2
1	B80099900100100	WRIGHT LEWIS SR & L JR & 2
64	X11499900004600	SMITH REX B & MARY H
44	Railroad Properties	RAILROAD PROPERTIES
49	State of Texas	STATE OF TEXAS
61	X01099900001200	RAZY BAHRAM
50	State of Texas	STATE OF TEXAS
24	L01199900003700	PUBLIC SERVICE BOARD OF THE
47	Railroad Properties	RAILROAD PROPERTIES
63	X11499900000200	CITY OF EL PASO
59	X01099900000550	CEMEX EL PASO INC
60	X01099900000560	CITY OF EL PASO
62	X054999000E1520	INDUSTRIAL TRADING INC
58	X01099900000230	ASARCO TEXAS CUSTODIAL TRUST
5	B80099900106500	EL PASO ELECTRIC CO
65	X11499900005500	CEMEX EL PASO INC
66	X11499900007300	CEMEX EL PASO INC

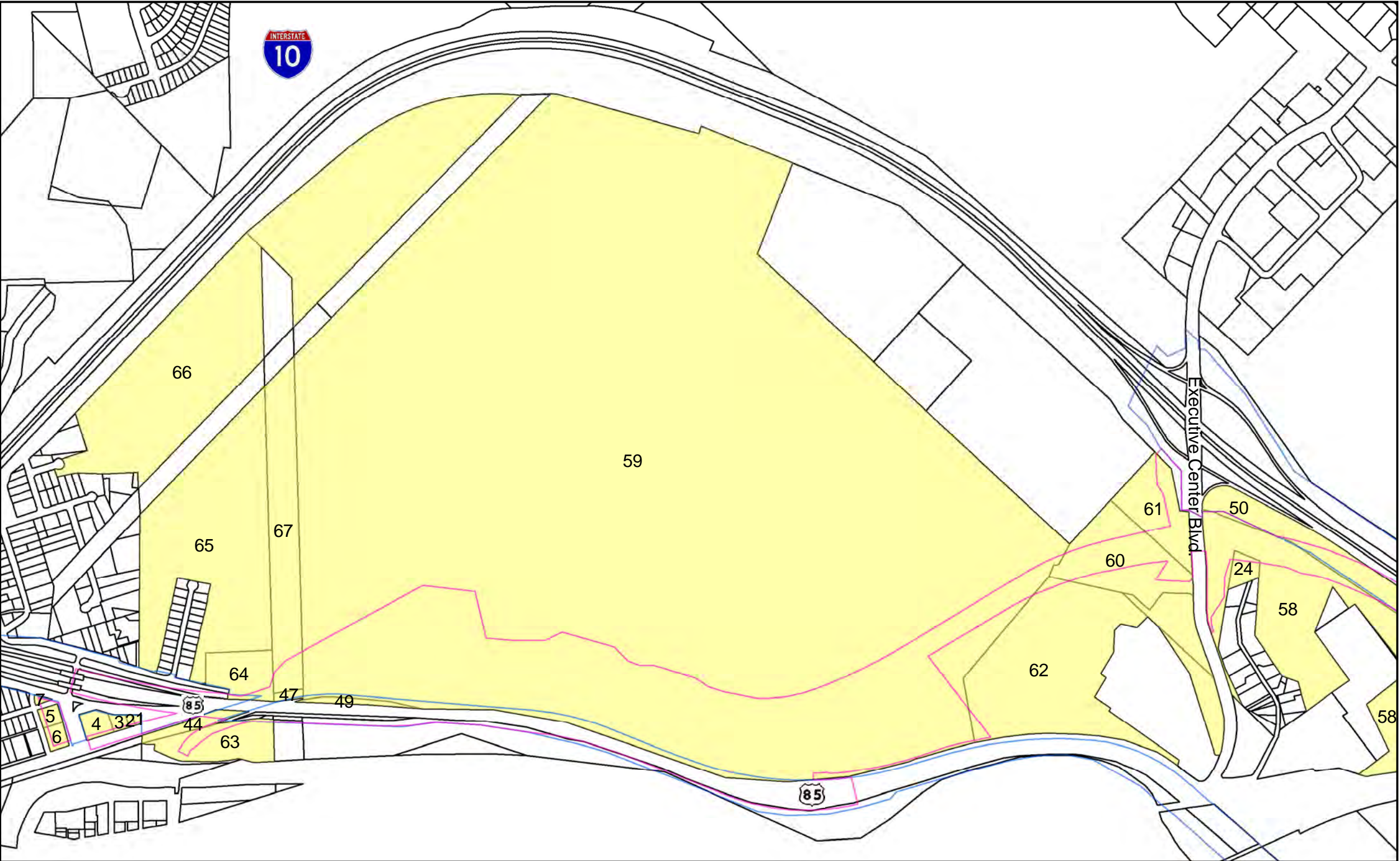

**Legend**

- Proposed ROW
- Existing ROW
- Parcels to be Acquired

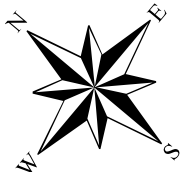

0 380 760 1,140 1,520 Feet

**PRELIMINARY**  
THIS PRINT IS FURNISHED FOR INFORMATION ONLY.  
THE PLAN INFORMATION OR OTHER DATA SHOWN HEREON IS  
SUBJECT TO CHANGE AND MUST NOT BE CONSTRUED AS FINAL.

© 2013 by Texas Department of Transportation  
(512) 416-2055; all rights reserved.

**DRAFT**



**Texas Department of Transportation** **HALFF**

**Loop 375 Border Highway West  
(BHW) Extension Project**  
From Racetrack Drive to East of Park Street

**Parcel Information**  
TxDOT EL Paso District  
CSJ: 2552-04-027



PARCEL #	PIDN	PROPERTY OWNER
61	X01099900001200	RAZY BAHRAM
50	State of Texas	STATE OF TEXAS
24	L01199900003700	PUBLIC SERVICE BOARD OF THE
59	X01099900000550	CEMEX EL PASO INC
60	X01099900000560	CITY OF EL PASO
62	X054999000E1520	INDUSTRIAL TRADING INC
58	X01099900000230	ASARCO TEXAS CUSTODIAL TRUST

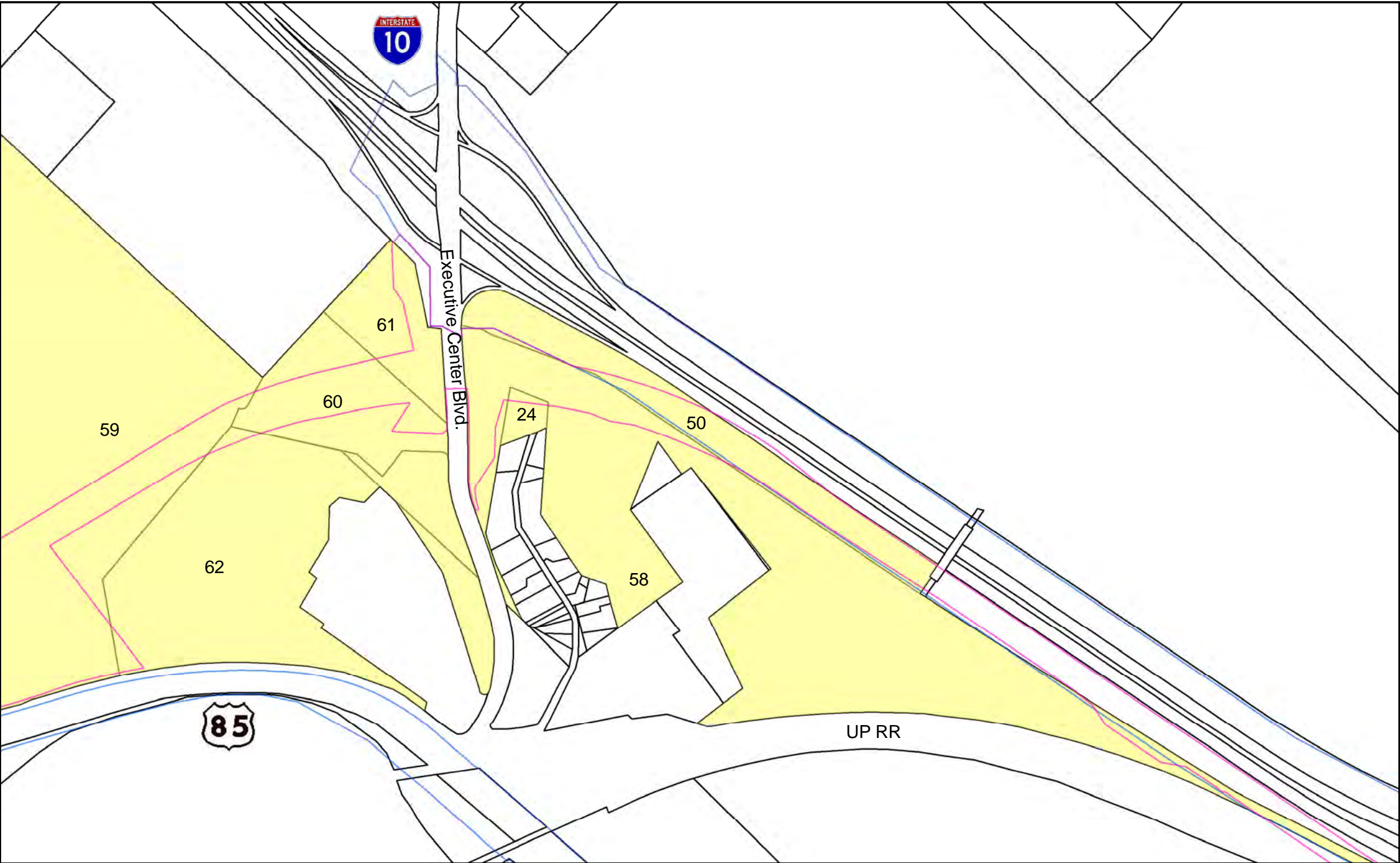

**Legend**

Proposed ROW

Existing ROW

Parcels to be Acquired

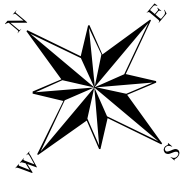

0 250 500 750 1,000 Feet

**PRELIMINARY**  
THIS PRINT IS FURNISHED FOR INFORMATION ONLY.  
THE PLAN INFORMATION OR OTHER DATA SHOWN HEREON IS  
SUBJECT TO CHANGE AND MUST NOT BE CONSTRUED AS FINAL.

© 2013 by Texas Department of Transportation;  
(512) 416-2055; all rights reserved.

DRAFT

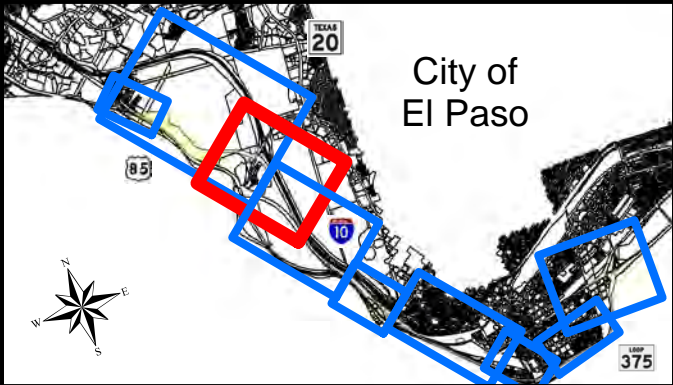

Texas Department of Transportation



**Loop 375 Border Highway West (BHW) Extension Project**  
From Racetrack Drive to East of Park Street  
**Parcel Information**  
TxDOT EL Paso District  
CSJ: 2552-04-027

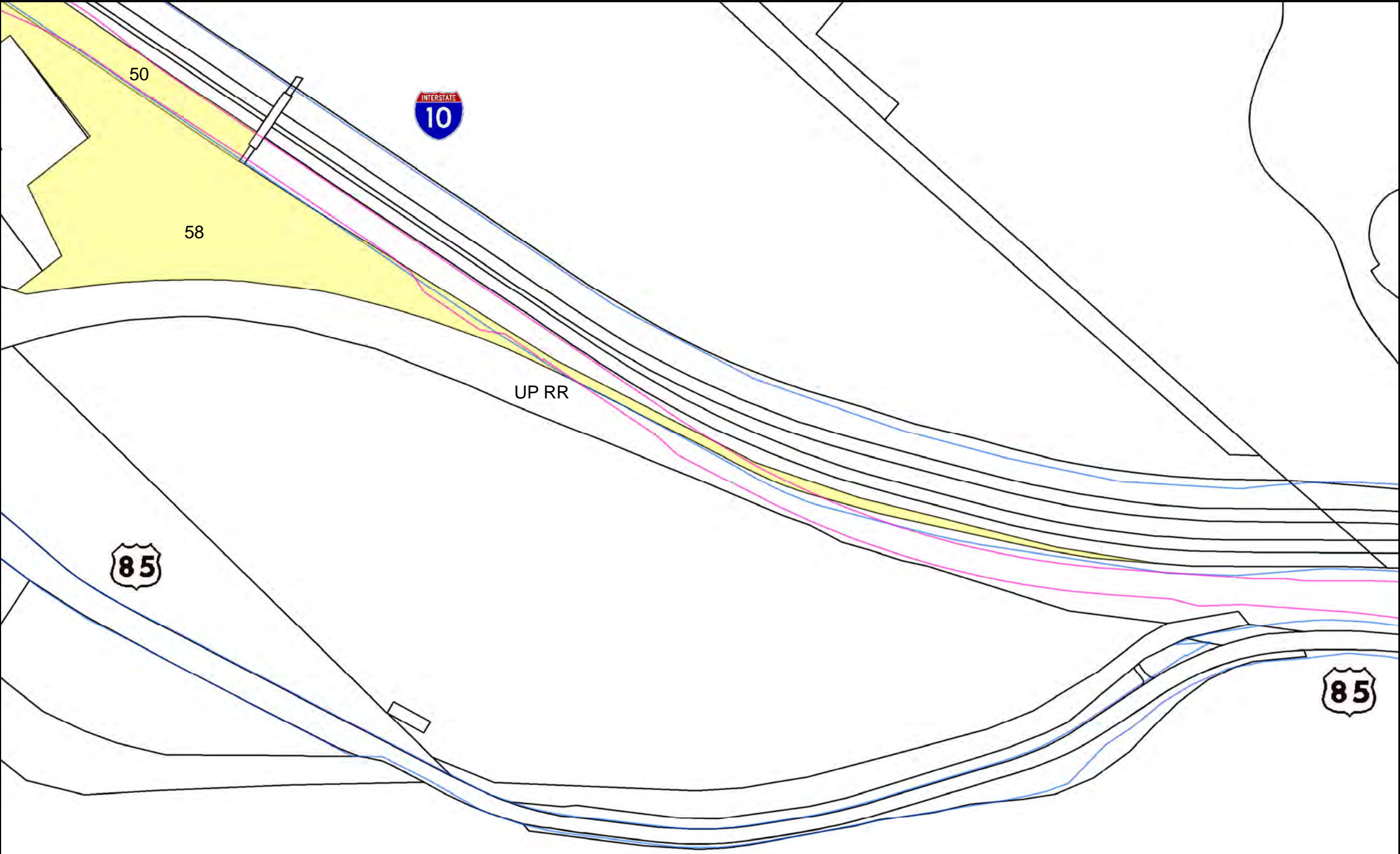

PARCEL #	PIDN	PROPERTY OWNER
50	State of Texas	STATE OF TEXAS
58	X01099900000230	ASARCO TEXAS CUSTODIAL TRUST



### Legend

-  Proposed ROW
-  Existing ROW
-  Parcels to be Acquired

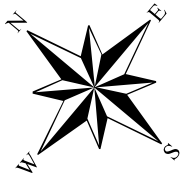

0 250 500 750 1,000 Feet

**PRELIMINARY**  
THIS PRINT IS FURNISHED FOR INFORMATION ONLY.  
THE PLAN INFORMATION OR OTHER DATA SHOWN HEREON IS  
SUBJECT TO CHANGE AND MUST NOT BE CONSTRUED AS FINAL.

© 2013 by Texas Department of Transportation  
(512) 416-2055; all rights reserved.

**DRAFT**

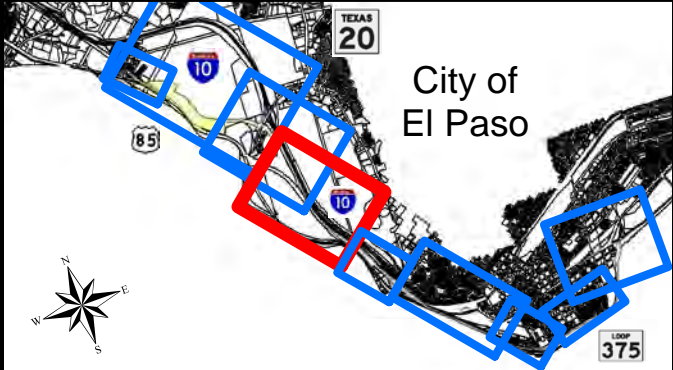

 **Texas Department of Transportation** 

**Loop 375 Border Highway West  
(BHW) Extension Project**  
From Racetrack Drive to East of Park Street

**Parcel Information**  
TxDOT EL Paso District  
CSJ: 2552-04-027



PARCEL #	PIDN	PROPERTY OWNER
48	RESCUE MISSION OF EP	THE RESCUE MISSION OF EL PASO
37	O18599900004900	PEOPLE OF THE STATE OF TEXAS
36	O18599900004700	THE RESCUE MISSION OF EL PASO
38	O18599900005100	RESCUE MISSION OF EL PASO INC
20	G49299900101700	HW MCKINNEY JR WRECKING INC
21	G49299900103300	RESCUE MISSION OF EL PASO INC
22	G49299900104900	RESCUE MISSION OF EL PASO INC
23	G49299900108100	ROBLES & SONS INC
45	Railroad Properties	RAILROAD PROPERTIES
35	O18599900004500	ROBLES & SONS INC
34	O18599900004300	CITY OF EL PASO
46	Railroad Properties	RAILROAD PROPERTIES

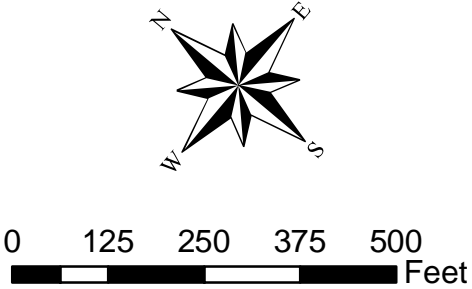
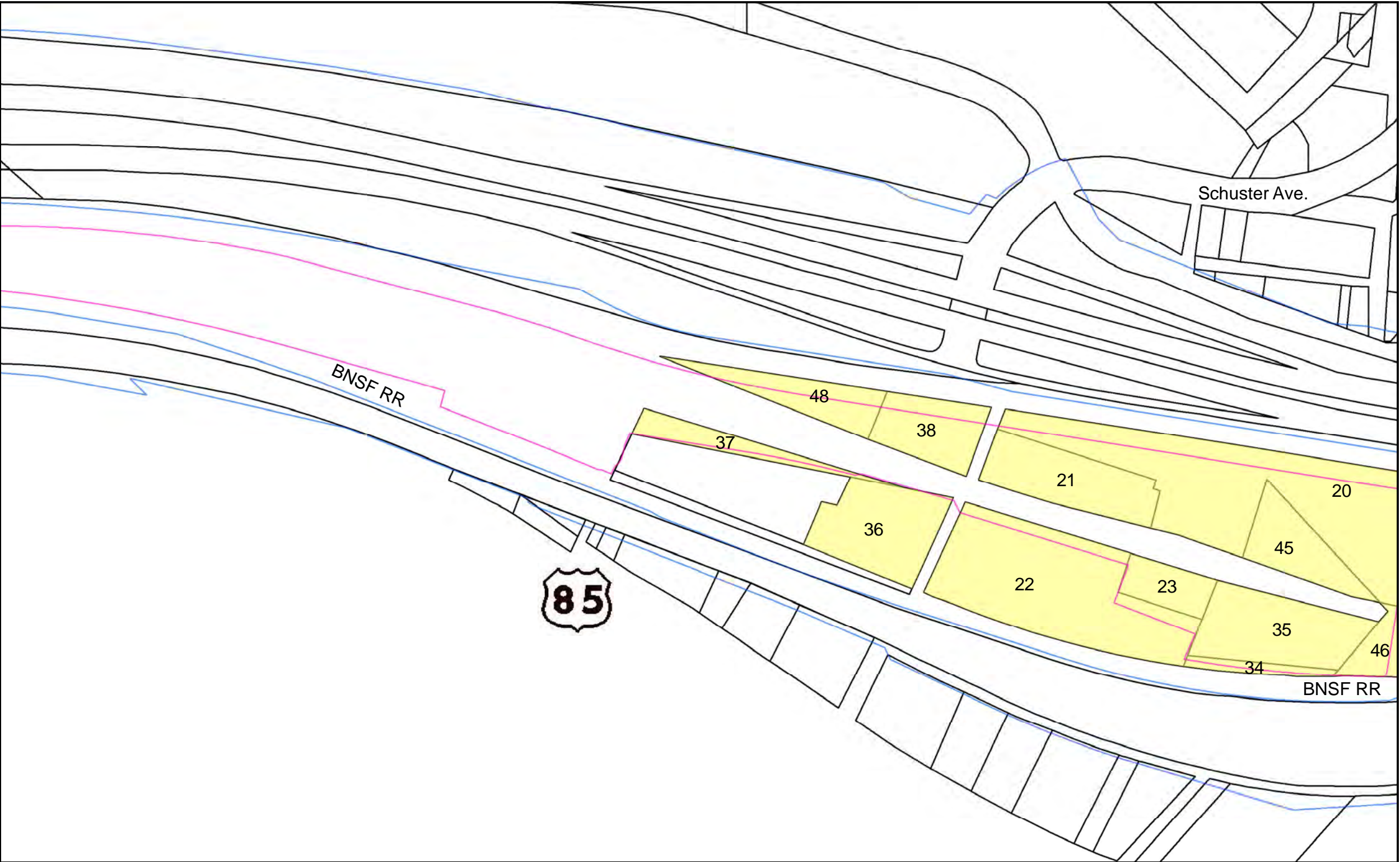



**PRELIMINARY**  
THIS PRINT IS FURNISHED FOR INFORMATION ONLY.  
THE PLAN INFORMATION OR OTHER DATA SHOWN HEREON IS  
SUBJECT TO CHANGE AND MUST NOT BE CONSTRUED AS FINAL.

© 2013 by Texas Department of Transportation  
(512) 416-2055; all rights reserved.

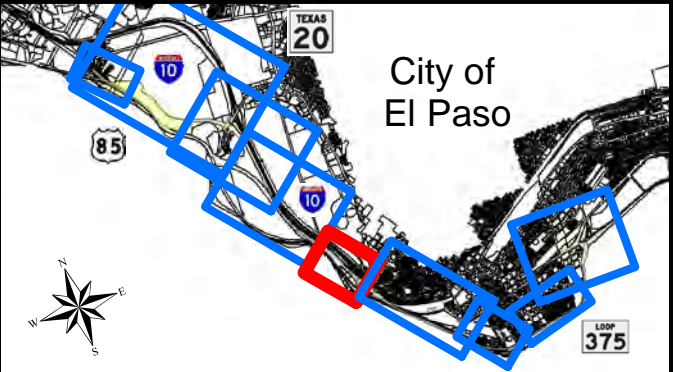
DRAFT





**Loop 375 Border Highway West (BHW) Extension Project**  
From Racetrack Drive to East of Park Street

**Parcel Information**  
TxDOT EL Paso District  
CSJ: 2552-04-027

Sheet 5 of 9

April 26, 2013



PARCEL #	PIDN	PROPERTY OWNER
39	Railroad Properties	RAILROAD PROPERTIES
33	M94699902400100	CITY OF EL PASO
18	City of El Paso	CITY OF EL PASO
40	Railroad Properties	RAILROAD PROPERTIES
42	Railroad Properties	RAILROAD PROPERTIES
43	Railroad Properties	RAILROAD PROPERTIES
69	X45099900005101	GOLDCROSS PROPERTIES
16	C05099913000100	W SILVER INVESTMENT AND HOLDING
68	X45099900005100	GOLDCROSS PROPERTIES
70	X47099900002000	EL PASO & SANTA FE RAILROAD
20	G49299900101700	HW MCKINNEY JR WRECKING INC
45	Railroad Properties	RAILROAD PROPERTIES
35	O18599900004500	ROBLES & SONS INC
34	O18599900004300	CITY OF EL PASO
46	Railroad Properties	RAILROAD PROPERTIES

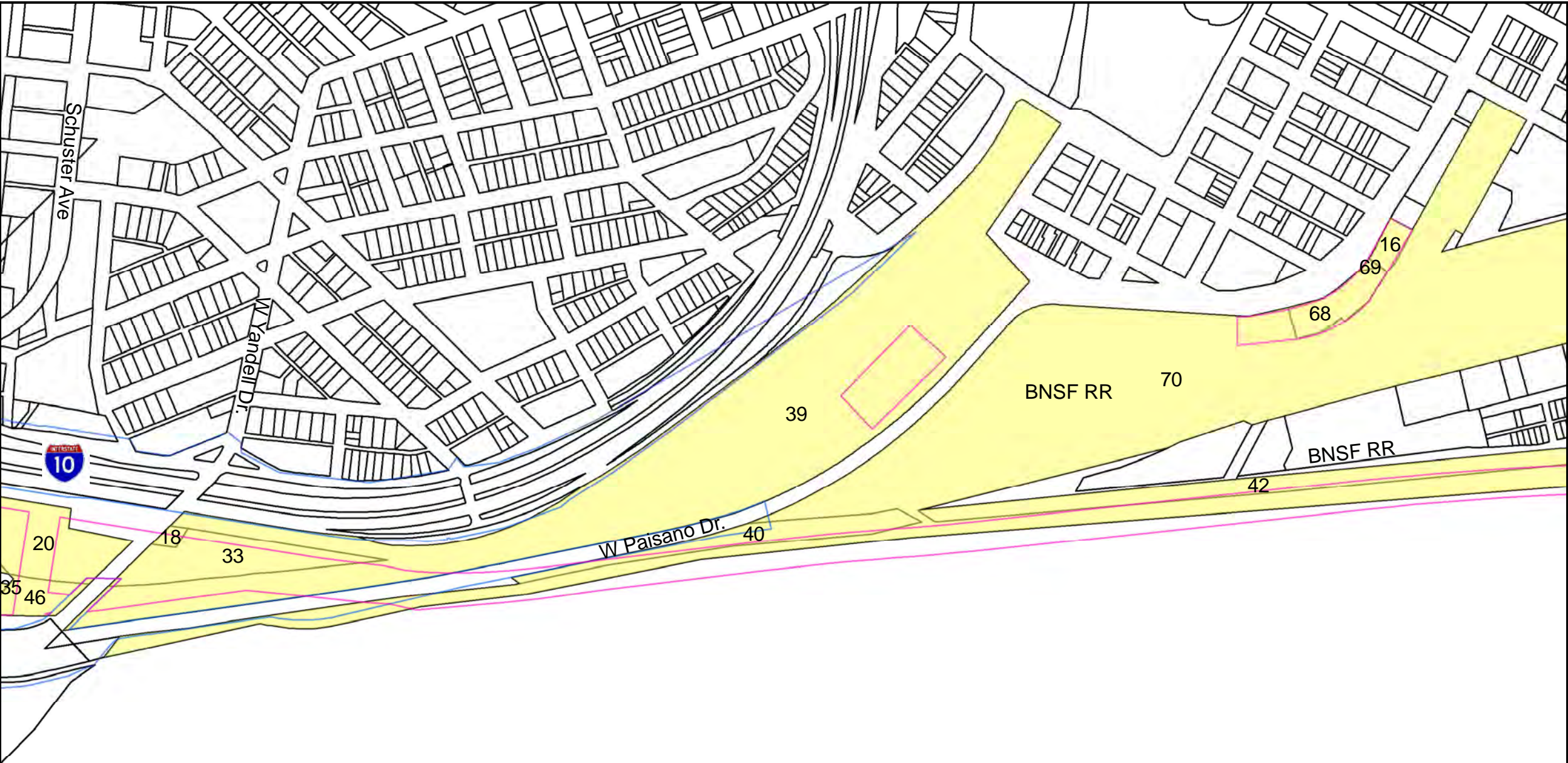

Legend

Proposed ROW

Existing ROW

Parcels to be Acquired

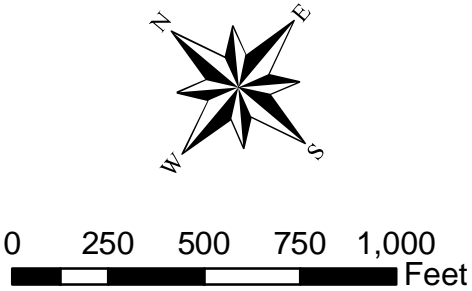

PRELIMINARY

THIS PRINT IS FURNISHED FOR INFORMATION ONLY.  
THE PLAN INFORMATION OR OTHER DATA SHOWN HEREON IS  
SUBJECT TO CHANGE AND MUST NOT BE CONSTRUED AS FINAL.

© 2013 by Texas Department of Transportation  
(512) 416-2055; all rights reserved.

DRAFT

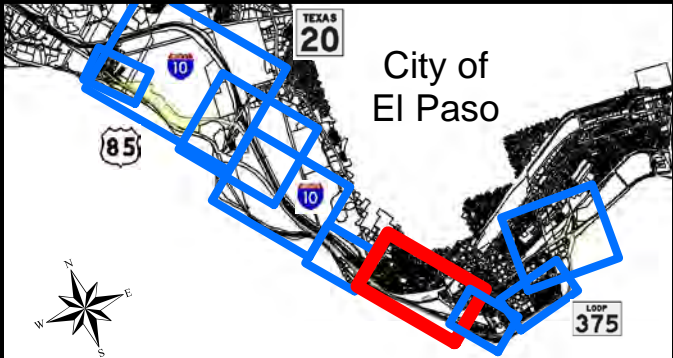

Loop 375 Border Highway West  
(BHW) Extension Project  
From Racetrack Drive to East of Park Street

Parcel Information  
TxDOT EL Paso District  
CSJ: 2552-04-027



PARCEL #	PIDN	PROPERTY OWNER
42	Railroad Properties	RAILROAD PROPERTIES
43	Railroad Properties	RAILROAD PROPERTIES
13	C05099906106100	MEUCHADIM OF TEXAS LTD
14	C05099906303700	UNITED STATES OF AMERICA (TR)
9	C05099904202100	LUCERO SAUL F II
10	C05099904204100	MACIAS RUBEN & GREGORIO
8	C05099904200100	UNITED STATES OF AMERICA (TR)
11	C05099904300100	BLK INVESTMENTS 1 FAMILY LP
51	U.S.A.	UNITED STATES OF AMERICA (TR)
69	X45099900005101	GOLDCROSS PROPERTIES
16	C05099913000100	W SILVER INVESTMENT AND HOLDING
68	X45099900005100	GOLDCROSS PROPERTIES
70	X47099900002000	EL PASO & SANTA FE RAILROAD
15	C05099907200100	MEUCHADIM OF TEXAS LTD
12	C05099906105100	MEUCHADIM OF TEXAS LTD
71	X47099900002500	EL PASO & SANTA FE RAILROAD
19	City of El Paso	CITY OF EL PASO

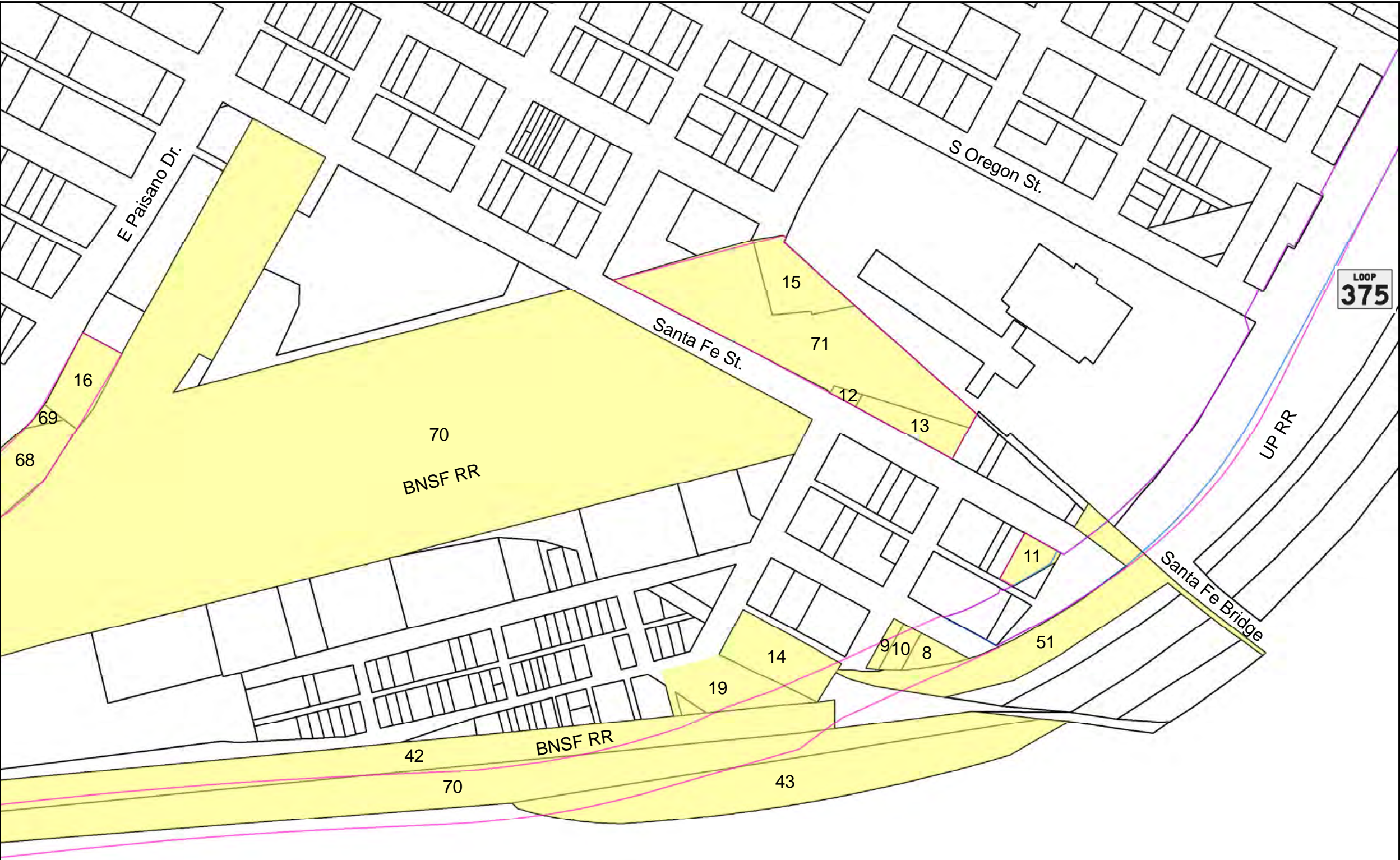

**Legend**

Proposed ROW

Existing ROW

Parcels to be Acquired

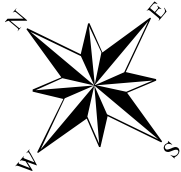

0 125 250 375 500 Feet

PRELIMINARY

THIS PRINT IS FURNISHED FOR INFORMATION ONLY.  
THE PLAN INFORMATION OR OTHER DATA SHOWN HEREON IS  
SUBJECT TO CHANGE AND MUST NOT BE CONSTRUED AS FINAL.

© 2013 by Texas Department of Transportation  
(512) 416-2055; all rights reserved.

DRAFT

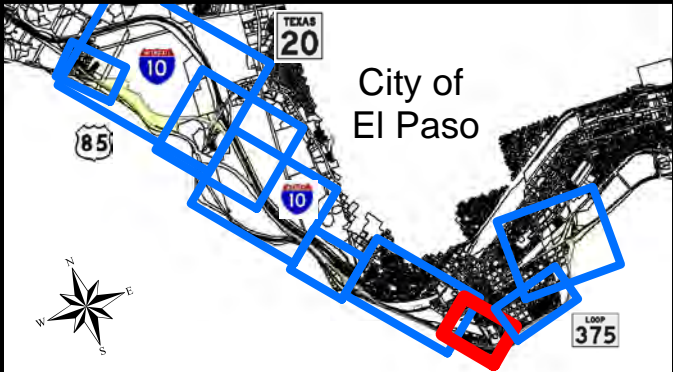

Texas Department of Transportation

Loop 375 Border Highway West  
(BHW) Extension Project  
From Racetrack Drive to East of Park Street

Parcel Information  
TxDOT EL Paso District  
CSJ: 2552-04-027





**Legend**

- Proposed ROW
- Existing ROW
- Parcels to be Acquired

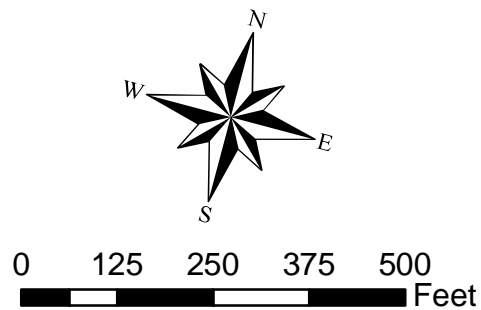

**PRELIMINARY**

THIS PRINT IS FURNISHED FOR INFORMATION ONLY.  
THE PLAN INFORMATION OR OTHER DATA SHOWN HEREON IS  
SUBJECT TO CHANGE AND MUST NOT BE CONSTRUED AS FINAL.

© 2013 by Texas Department of Transportation;  
(512) 416-2055; all rights reserved.

DRAFT

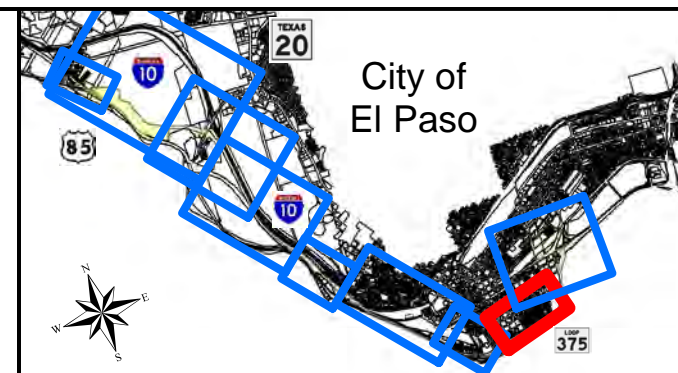





**Loop 375 Border Highway West  
(BHW) Extension Project**  
From Racetrack Drive to East of Park Street

**Parcel Information**  
TxDOT EL Paso District  
CSJ: 2552-04-027

Sheet 8 of 9
April 26, 2013

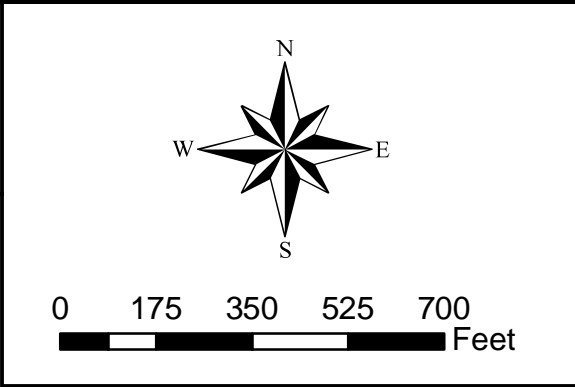
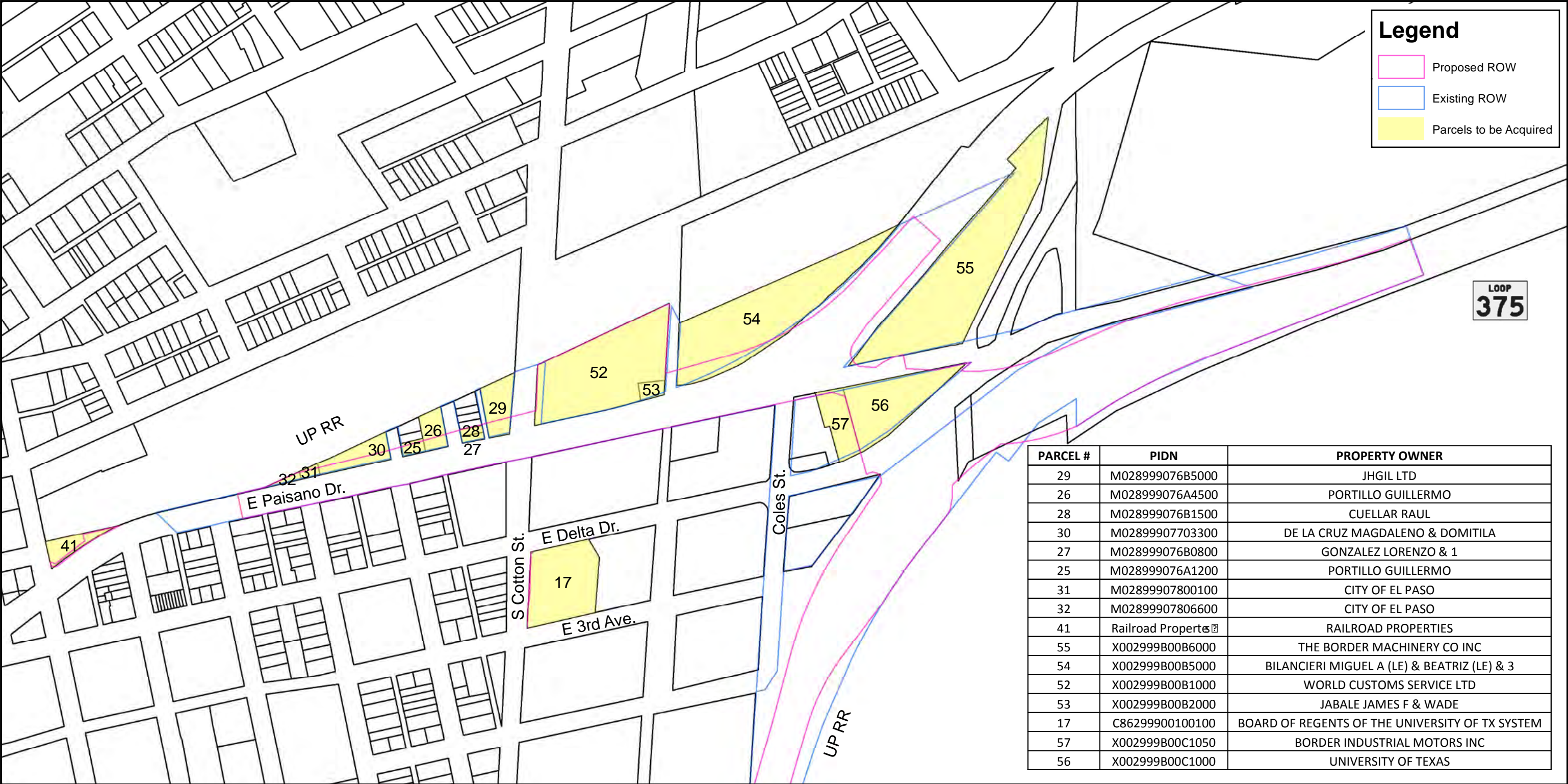



**PRELIMINARY**  
THIS PRINT IS FURNISHED FOR INFORMATION ONLY.  
THE PLAN INFORMATION OR OTHER DATA SHOWN HEREON IS  
SUBJECT TO CHANGE AND MUST NOT BE CONSTRUED AS FINAL.

**DRAFT**

© 2013 by Texas Department of Transportation;  
(512) 416-2055; all rights reserved.

