



BWX - CEI Bryan District Procurement – FY 24 WV 3

Solicitation No. 601CT0000005848
RFP NO. 17-4SDP5001

Pre-Request for Proposal (RFP) Meeting

Thursday, March 21, 2024





Thanks for joining our virtual meeting!

- Be sure your full name is showing up correctly to provide your information on the attendee list.
- Please ensure your audio is muted and video turned off.
- Note that all correspondence will be muted throughout this presentation.
- There **will not** be an opportunity to ask questions during the Pre- RFP presentation.
- You **will** be given an opportunity to ask questions after the presentation via an **email request**.



HELP
#EndTheStreakTX

End the streak of daily deaths on Texas roadways.

TxDOT.gov (Keyword: #EndTheStreakTX)



#EndTheStreakTX Toolkit



Pre-RFP Meeting Agenda



1	Introductions/Ground Rules	PEPS
2	Procurement Process	PEPS
3	Preclusions/Restrictions	PEPS
4	RFP Requirements	PEPS
5	Project Overview	Bryan District
6	Procurement Timeline (Tentative)	PEPS
7	Wrap Up and Next Steps	PEPS



PLEASE - Do NOT Contact the CST Members

- PEPS Central Service Center Manager (LRD)
 - Jaime A. Vela, Jr., P.E.

- PEPS Procurement Engineer (BRY)
 - Allison Kurwitz, P.E.

- PEPS Contract Specialist (TBD)
 - TBD

- Consultant Selection Team (CST) members:
 - Joe Seago, P.E.: Transportation Engineer – Bryan District (BRY)
 - Joseph Greive, P.E.: Assistant Area Engineer – Bryan Area Office – Bryan District (BRY)
 - Blake Knox, P.E.: Transportation Engineer – Design Section – Bryan District (BRY)



GROUND RULES

1. Do not contact CST members during procurement process.
2. Communication is one-way during this presentation.
3. Brief Presentation – Information Purposes Only
4. All questions must be emailed to allison.Kurwitz@txdot.gov .
by 5:00 p.m. on **Tuesday, March 26, 2024**.
Subject line: 5848 Pre-RFP Meeting Question

Pre-RFP Meeting Agenda



1	Introductions/Ground Rules	PEPS
2	Procurement Process	PEPS
3	Preclusions/Restrictions	PEPS
4	RFP Requirements	PEPS
5	Project Overview	Bryan District
6	Procurement Timeline (Tentative)	PEPS
7	Wrap Up and Next Steps	PEPS



One Specific Deliverable Contracts without Work Authorizations Contract Duration: Approx. 4 Years



FEDERAL FUNDS

DBE GOAL

- 15%

FEDERAL PROCESS WITH INTERVIEWS

- Solicitation – The Request for Proposal (RFP)
- Response – Proposal submitted in Bonfire
- Short List – Based on the proposal scores
- Interviews – Provider presentation
- Selection – Based on the interview scores



- **Post Request for Proposal (RFP)**
 - Electronic State Business Daily (ESBD): Minimum 21-day posting time for RFP.
 - Solicitation will be posted in Bonfire.

- **Submit Responses**
 - Providers will use Bonfire to submit responses to the solicitation.
 - Bonfire [Frequently Asked Questions \(FAQs\) \(state.tx.us\)](https://state.tx.us)
 - Follow the RFP instructions and submit all completed, applicable documents required.
 - Use the latest version of all forms.



- **RFP Screening**
 - RFP Screening Checklist [Architectural, Engineering and Surveying Consultants \(state.tx.us\)](#)
 - All prime and subs providing engineering and design-related services must be Administratively Qualified (AQ); or be determined eligible by TxDOT's PEPS Division, Business Operations Center - Administrative Qualification Group to use the federal safe harbor rate, by the RFP deadline specified in this solicitation.
 - Primes can look up subs on the TxDOT.gov website to check on AQ status. [Firms Eligible to Do Business with TxDOT](#)
- **Proposal Evaluation**
 - Short list based on proposal scores



- **Interview**

- Shortlisted firms will receive the Interview Contract Guide (ICG) that outlines the process, presentation topics, and scoring criteria
- Interviews will consist of Provider presentations, and follow-up questions and answer session.
- Selection based on interview scores.

- **Negotiations**

- Hourly Labor Rates, Unit Cost, ODE
- Negotiate Scope, budget, and work schedule.
- Level of Effort

- **Execute Contract**



RFP

Provide all completed documents in the Cover Page List of Attachments

RFP statement is developed to guide your response to focus on the needs for this contract.

Refer to the RFP for additional information.

Past Performance Score will be captured at the RFP phase, not in interview.

RFP Responses We're Looking For:

We are interested in meeting the contract goals and consultant characteristics –

Tailor RFP responses to answer information requested

.....

Tell us about your experience– Provide detailed examples and include challenges/lessons learned and innovation

.....

Quality over quantity – One or two great examples are better than several good/average ones

.....

Thoughtful relevant responses– No keyword search; this is about your capabilities, experience, knowledge, and thought process

.....



Interview and Contract Guide (ICG)

TxDOT will provide the following:

- Scope of work with technical requirements and qualifications required to provide the services of this contract
- Presentation Topics
- Identify interview evaluation criteria
- Interview format and timetable
- Interview schedule date, time and location

Typical Interview process *

- TxDOT Introductions/Instructions
- Provider presentation based on topics shown in ICG
- CST Break
- Questions and Answer Session
- TxDOT and Provider Concluding Remarks

*Interviews in-person: Bryan District

- The CST members individually score the interviews and then the scores are consolidated to determine the selected provider.

Pre-RFP Meeting Agenda



1	Introductions/Ground Rules	PEPS
2	Procurement Process	PEPS
3	Preclusions/Restrictions	PEPS
4	RFP Requirements	PEPS
5	Project Overview	Bryan District
6	Procurement Timeline (Tentative)	PEPS
7	Wrap Up and Next Steps	PEPS

Preclusions/Restrictions



➤ Precluded Firms*

17-948P5001 WA 3

Prime: Consor Engineers, LLC

15-8IDP5018 WA 5

Prime: Consor Engineers, LLC

Subprovider: Arcadis U.S., Inc.

15-8IDP5018 WA 6

Prime: Consor Engineers, LLC

Subproviders: Corsair Consulting, LLC

Entech Civil Engineers, Inc

36-2IDP5021 WA 2 (Not Executed)

Prime: Consor Engineers, LLC

Subproviders: Entech Civil Engineers, Inc

MV Engineering, LLC

* List is subject to change – current as of 3/21/2024

Preclusions/Restrictions



➤ Precluded Firms*

17-948P5002 WA 3

Prime: Aguirre & Fields, LP

Subproviders: Kennedy Consulting, Ltd. (KCI Technologies)

Teague Nall and Perkins, Inc. (H&H Resources, Inc.)

36-0IDP5040 WA 1

Prime: HDR Engineering, Inc

Subprovider: Midtown Engineers, LLC

17-0IDP5004 WA 10

Prime: H W Lochner, Inc.

Subprovider: Foresight Planning & Engineering Services, LLC

➤ Core Team Restrictions

▪None anticipated

* List is subject to change – current as of 3/21/2024



➤ Preclusion Appeals Process

- Preclusion document has been developed.
 - Email Martin L. Rodin, P.E.
 - Include this Solicitation No. 601CT0000005848
 - Explain rationale for removal from preclusion list
- After posting procurement
 - Formal appeal outlined in [Title 43 TAC § 9.7](#), see for exact details
 - Mail letter to Marc D. Williams, include above info
 - CC: Martin L. Rodin
 - Procurement process is not paused

Pre-RFP Meeting Agenda



1	Introductions/Ground Rules	PEPS
2	Procurement Process	PEPS
3	Preclusions/Restrictions	PEPS
4	RFP Requirements	PEPS
5	Project Overview	Bryan District
6	Procurement Timeline (Tentative)	PEPS
7	Wrap Up and Next Steps	PEPS



Project Team Composition (PTC) Form (Parts 1, 2, and 3) must include:

- TLs for standard work categories
- DBE firms
- Percentages of work

Examples of Standard Work Categories

11.1.1 Roadway Construction Manage. And Inspect.

11.2.1 Bridge Const. Management and Inspect.

11.3.1 Construction Superintendent

11.10.1 Construction Record Keeper

12.1.5 Portland Cement Concrete Placement

18.5.1 Utility Const. Manage. and Verification

- Prime provider shall perform at least **30%** of the contracted work using its own work force.
- DBE goal is **15%**.

RFP Requirements



Work Categories

1.8.1	Public Involvement
7.3.1	Traffic Signal Timing
11.1.1	Roadway Construction Management and Inspection
11.2.1	Bridge Construction Management and Inspection
11.3.1	Construction Superintendent
11.4.1	Environmental Inspections
11.5.1	Construction Scheduling Project Manager
11.6.1	Construction Schedule Support - General
11.8.1	Construction Schedule Support – Relating to Construction Management of Projects Including Bridges or Multilevel Interchanges
11.9.1	Railroad Coordination Management During Construction
11.10.1	Construction Record Keeper
12.1.1	Asphaltic Concrete Production
12.1.2	Portland Cement Concrete

* Subject to change. Refer to RFP for list and percentages.

RFP Requirements



Work Categories

12.1.3	Materials Engineering
12.1.4	Asphaltic Concrete Placement
12.1.5	Portland Cement Concrete Placement
12.1.6	Embankment/Subgrade/Backfill/Base Production
12.1.7	Embankment/Subgrade/Backfill/Base Placement
12.2.1	Concrete Plant Inspection And Testing
12.2.5	Hot Mix Asphalt (HMA) Plant Inspection and Testing
14.1.1	Soil Exploration
14.2.1	Geotechnical Testing
15.2.1	Design Survey
15.2.2	Construction Survey
18.2.1	Subsurface Utility Engineering (Util Engr. Investigation)
18.5.1	Utility Construction Management and Verification

* Subject to change. Refer to RFP for list and percentages.



Proposal evaluation criteria

The CST members will independently score the proposals based on the criteria and relative importance factors (weightings) provided below. The proposal scores will be used to determine the short list.

Evaluation Criteria	PROPOSAL SHOULD INCLUDE	Weighting for Evaluation of Proposal
Technical approach	Project understanding, project approach, innovative concepts or alternatives	XX
Project Manager's relevant experience	Experience with similar or related projects, including both technical and management experience	XX
Project Planning and Management	Project staffing and resource management (who, how, and why), communication plan, and quality control procedures. Includes the prime firm's past experience with utilizing subproviders and meeting program goals (HUB or DBE) and/or how it plans to utilize subproviders to meet the goals on this contract. Also may include project scheduling or phasing for SD projects	XX
Key staff's relevant experience	Experience with similar projects	XX
Past Performance Score		5 to 10%
Total		100%

Pre-RFP Meeting Agenda



1	Introductions/Ground Rules	PEPS
2	Procurement Process	PEPS
3	Preclusions/Restrictions	PEPS
4	RFP Requirements	PEPS
5	Project Overview	Bryan District
6	Procurement Timeline (Tentative)	PEPS
7	Wrap Up and Next Steps	PEPS



- County: Brazos
- Overall Limits: The Intersection of George Bush (FM 2347), Wellborn Road (FM 2154) and UPRR
- Functional Classification: 4-Lane Major Arterial
- Proposed Letting Date: December 2025
- Scope: Construct grade separation including RR & Ped/Bike structures, drill shaft, soil nail & MSE walls, stormwater pump station, detention pond, and traffic signals.

Bryan District, BWX Project Overview: Location Map

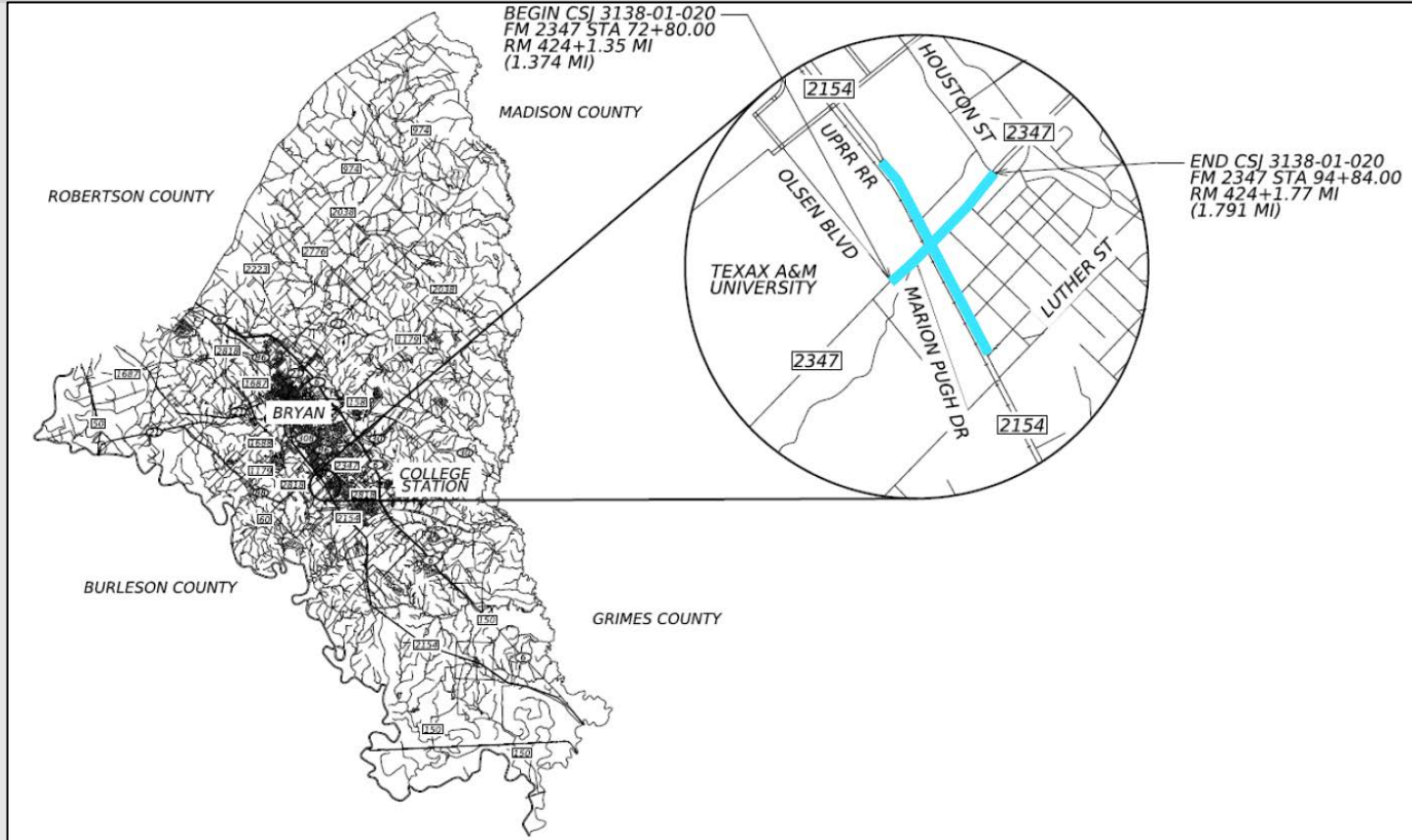

Bryan District, BWX Project Overview: Layout

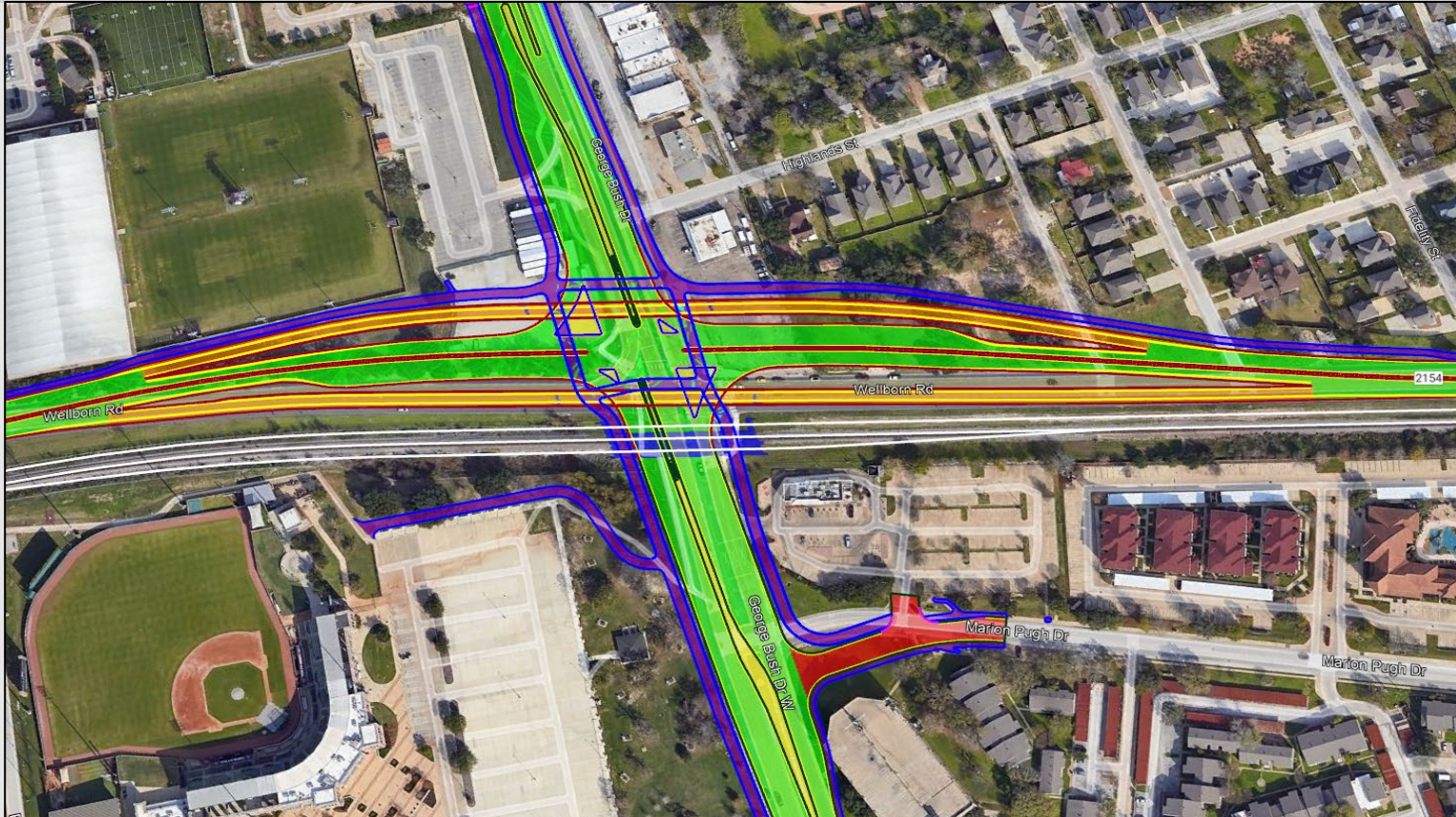

Bryan District, BWX Project Overview: Rendering

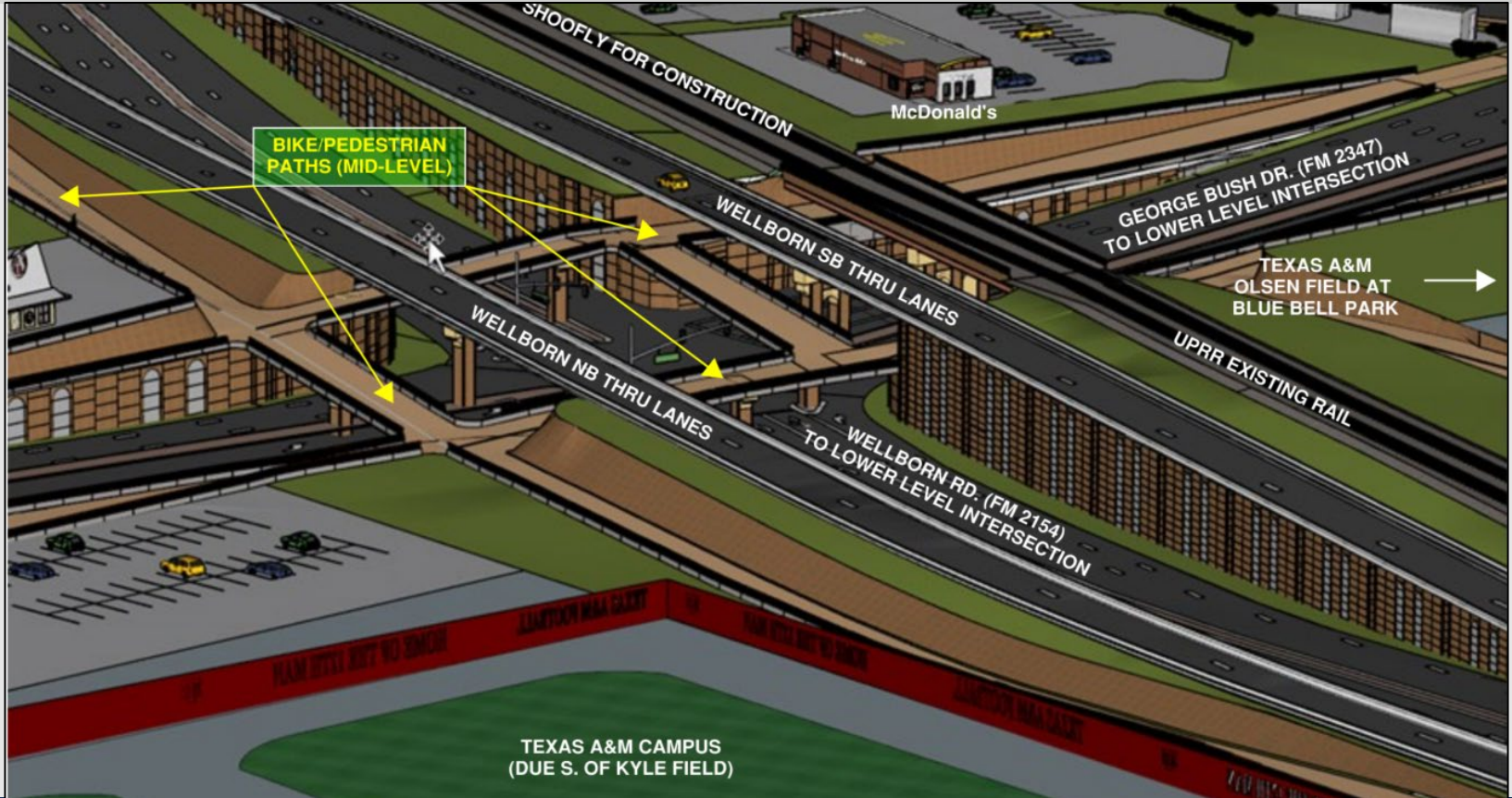

Bryan District, BWX Project Overview: Existing Intersection Configuration



Bryan District, BWX Project Overview: Proposed Intersection Configuration

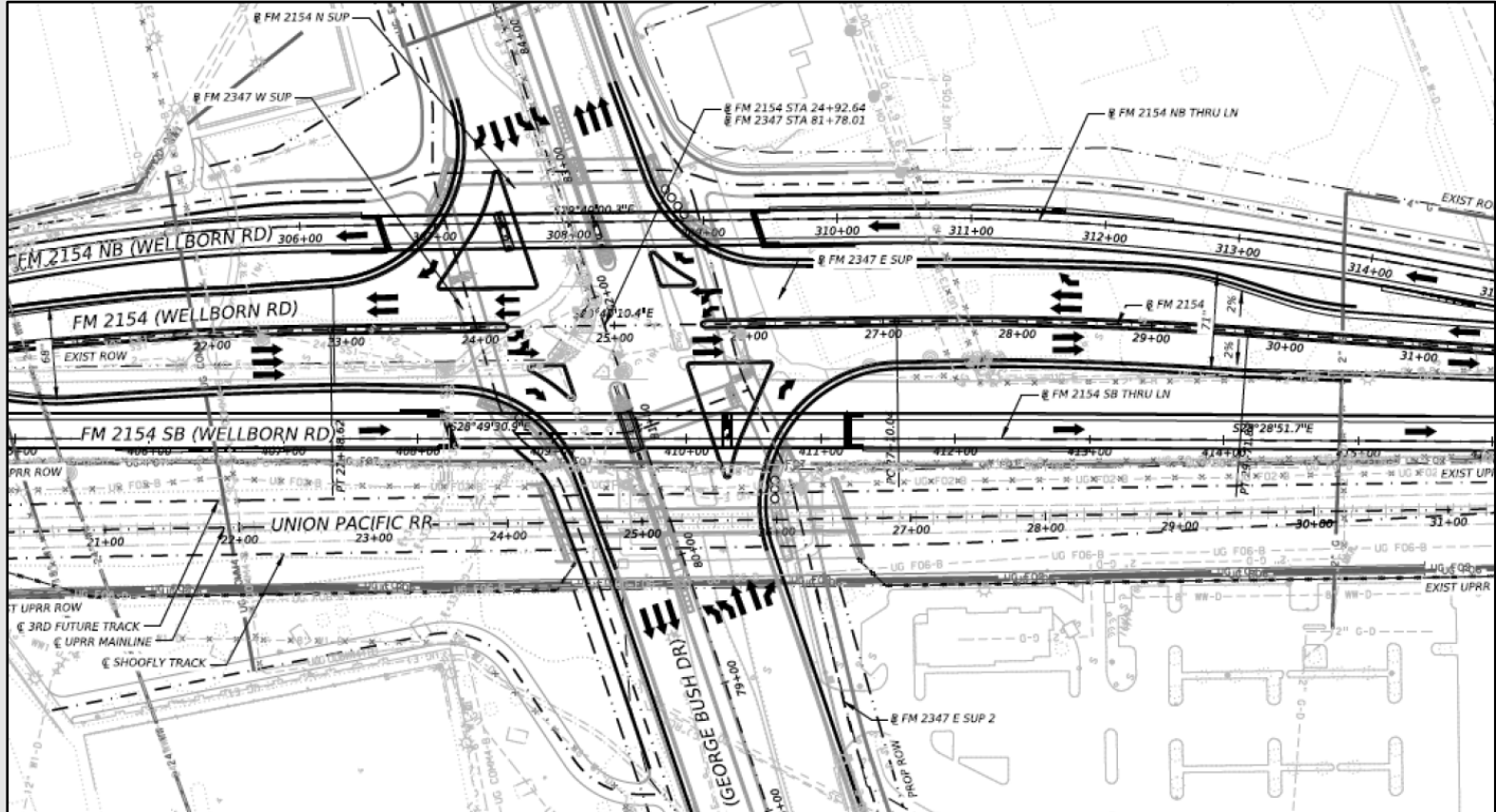



- Stakeholders
- UPRR
 - 20+ trains/day; adds to coordination effort
- Compressed Schedule
 - Milestones; Lane Rentals; A+B+B+ (used by WAC on IH 35)
- 24/7
 - Allows max time for contractor to run 2 shifts
- Hole in the Ground
 - Intersection is 35-ft below existing ground; pump station
- Walls & Bridges
 - Drill Shaft, Soil Nail & MSE Walls
 - Roadway, Ped/Bike, & RR Structures



- BWX PS&E:
 - Any additional documents will be made available in Bonfire.

- Right-of-Way:
 - 3 Parcels & 1 Easement remain to be acquired

- Utilities:
 - Actively relocating all utilities. On schedule to be completed ahead of proposed letting date.

Pre-RFP Meeting Agenda



1	Introductions/Ground Rules	PEPS
2	Procurement Process	PEPS
3	Preclusions/Restrictions	PEPS
4	RFP Requirements	PEPS
5	Project Overview	Bryan District
6	Procurement Timeline (Tentative)	PEPS
7	Wrap Up and Next Steps	PEPS



Tentative* Procurement Schedule

Pre-RFP meeting	Thursday, March 21, 2024
RFP Posted in Bonfire	Thursday, March 28, 2024
Proposal Closing Date	Thursday, April 18, 2024
Proposal Evaluation Complete	Week of May 6 th
Interviews	Weeks of May 28 th Or June 3 rd
Provider Selection	Week of June 10 th
Finalize & Execute Contract	November 2024
Debriefs to be scheduled after notification of the selected firm.	

*** All dates subject to change**

Pre-RFP Meeting Agenda



1	Introductions/Ground Rules	PEPS
2	Procurement Process	PEPS
3	Preclusions/Restrictions	PEPS
4	RFP Requirements	PEPS
5	Project Overview	Bryan District
6	Procurement Timeline (Tentative)	PEPS
7	Wrap Up and Next Steps	PEPS



Thank you all for joining the Pre-RFP meeting!

- Email all questions from the Pre-RFP meeting to Allison.Kurwitz@txdot.gov by 5:00 p.m. CST, on **Tuesday, March 26, 2024**.

Subject line: **5848 Pre-RFP Meeting Question**.

- Pre-RFP presentation, attendee list, relevant questions/answers and project documents will be posted to TxDOT website under “Consultant Information Meetings”:

[Pre-RFP Meeting – BWX CEI – Bryan District](#)